

## SERIE NDZ

NDZ series | Série NDZ



### FUSIBILI DI DI fuses | Fusibles DI

<b>Tensione</b> 500 V	<b>Voltage</b> 500 V	<b>Tension</b> 500 V
<b>Capacità di rottura</b> 50.000 A	<b>Breaking capacity</b> 50.000 A	<b>Pouvoir de coupure</b> 50.000 A
<b>Classe di isolamento</b> C - VDE 0110	<b>Insulating class</b> C - VDE 0110	<b>Classe d'isolation</b> C - VDE 0110
<b>Norme riferimento</b> IEC 60269-3-1 DIN/EN 60269.1/3 DIN VDE 0636/301	<b>Standards</b> IEC 60269-3-1 DIN/EN 60269.1/3 DIN VDE 0636/301	<b>Normes</b> IEC 60269-3-1 DIN/EN 60269.1/3 DIN VDE 0636/301
<b>Per basi</b> E 16	<b>For fuse bases</b> E 16	<b>Pour bases</b> E16



Corrente nominale Rated current Courant nominal	Codice Code Code	Colore Colour Couleur	ØA ØA ØA	ØB ØB ØB
<b>Rapidi   Fast   Rapides</b>				
2 A	ND1F002	■	13,2	6
4 A	ND1F004	■	13,2	6
6 A	ND1F006	■	13,2	6
10 A	ND1F010	■	13,2	8
16 A	ND1F016	■	13,2	10
20 A	ND1F020	■	13,2	12
25 A	ND1F025	■	13,2	14
•30 A	ND1F030	-	-	-
•35 A	ND1F035	-	-	-
•40 A	ND1F040	-	-	-
•50 A	ND1F050	-	-	-

<b>Ritardati @ gG   Time delay   Temporisés @gG</b>				
2 A	ND1T002	■	13,2	6
4 A	ND1T004	■	13,2	6
6 A	ND1T006	■	13,2	6
10 A	ND1T010	■	13,2	8
16 A	ND1T016	■	13,2	10
20 A	ND1T020	■	13,2	12
25 A	ND1T025	■	13,2	14
•30 A	ND1T030	-	-	-
•35 A	ND1T035	-	-	-
•40 A	ND1T040	-	-	-
•50 A	ND1T050	-	-	-

### Dimensioni | Dimensions | Dimensions

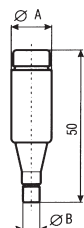

10/500 pz.  
10/500 pcs  
10/500 pces



pronta  
in stock  
en stock



• valori fuori norma  
ratings not included in the standards  
valeurs non standards



### FUSIBILI DII DII fuses | Fusibles DII

<b>Tensione</b> 500 V	<b>Voltage</b> 500 V	<b>Tension</b> 500 V
<b>Capacità di rottura</b> 50.000 A	<b>Breaking capacity</b> 50.000 A	<b>Pouvoir de coupure</b> 50.000 A
<b>Classe di isolamento</b> C - VDE 0110	<b>Insulating class</b> C - VDE 0110	<b>Classe d'isolation</b> C - VDE 0110
<b>Norme riferimento</b> IEC 60269-3-1 IEC/EN 60269.1/3 DIN VDE 0636/301	<b>Standards</b> IEC 60269-3-1 IEC/EN 60269.1/3 DIN VDE 0636/301	<b>Normes</b> IEC 60269-3-1 IEC/EN 60269.1/3 DIN VDE 0636/301
<b>Per basi</b> E 27	<b>For fuse bases</b> E 27	<b>Pour bases</b> E 27



Corrente nominale Rated current Courant nominal	Codice Code Code	Colore Colour Couleur	ØA ØA ØA	ØB ØB ØB
<b>Rapidi   Fast   Rapides</b>				
2 A	ND2F002	■	21,5	6
4 A	ND2F004	■	21,5	6
6 A	ND2F006	■	21,5	6
10 A	ND2F010	■	21,5	8
16 A	ND2F016	■	21,5	10
20 A	ND2F020	■	21,5	12
25 A	ND2F025	■	21,5	14
•30 A	ND2F030	-	-	-
•35 A	ND2F035	-	-	-
•40 A	ND2F040	-	-	-
•50 A	ND2F050	-	-	-

<b>Ritardati @ gG   Time delay   Temporisés @gG</b>				
2 A	ND2T002	■	21,5	6
4 A	ND2T004	■	21,5	6
6 A	ND2T006	■	21,5	6
10 A	ND2T010	■	21,5	8
16 A	ND2T016	■	21,5	10
20 A	ND2T020	■	21,5	12
25 A	ND2T025	■	21,5	14
•30 A	ND2T030	-	-	-
•35 A	ND2T035	-	-	-
•40 A	ND2T040	-	-	-
•50 A	ND2T050	-	-	-

### Dimensioni | Dimensions | Dimensions

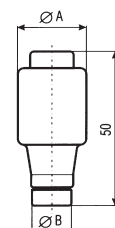

5/500 pz.  
5/500 pcs  
5/500 pces



pronta  
in stock  
en stock



• valori fuori norma  
ratings not included in the standards  
valeurs non standards