



A304-IP68

MATERIAL : ABS	
Dark Grey Lid + Dark Grey Base	EXTERNAL DIMENSION (mm)
ITEM NO.	
A302-IP68	64 x 58 x 35
A304-IP68	115 x 65 x 40
A308-IP68	115 x 65 x 55
A311-IP68	115 x 90 x 55
A313-IP68	171 x 121 x 55
A317-IP68	222 x 146 x 55
A331-IP68	115 x 90 x 80
A340-IP68	171 x 121 x 80
A346-IP68	195 x 80 x 55
A353-IP68	222 x 146 x 75
A362-IP68	52 x 50 x 35
A366-IP68	82 x 80 x 55
A368-IP68	160 x 80 x 55
A369-IP68	160 x 80 x 85
A386-IP68	120 x 120 x 60
A387-IP68	120 x 120 x 90
A396-IP68	160 x 160 x 60
A399-IP68	160 x 160 x 90
A3735-IP68	200 x 120 x 75
A3783-IP68	265 x 185 x 95
A3008-IP68	240 x 160 x 90
A3019-IP68	240 x 160 x 120
A30285-IP68	300 x 230 x 86
A30312-IP68	300 x 230 x 111
A30393-IP68	360 x 200 x 150

▲ Lid fixing screws are M4 stainless steel (non-magnetic) into threaded brass inserts.

P201-IP68 / P201C-IP68 / A302-IP68

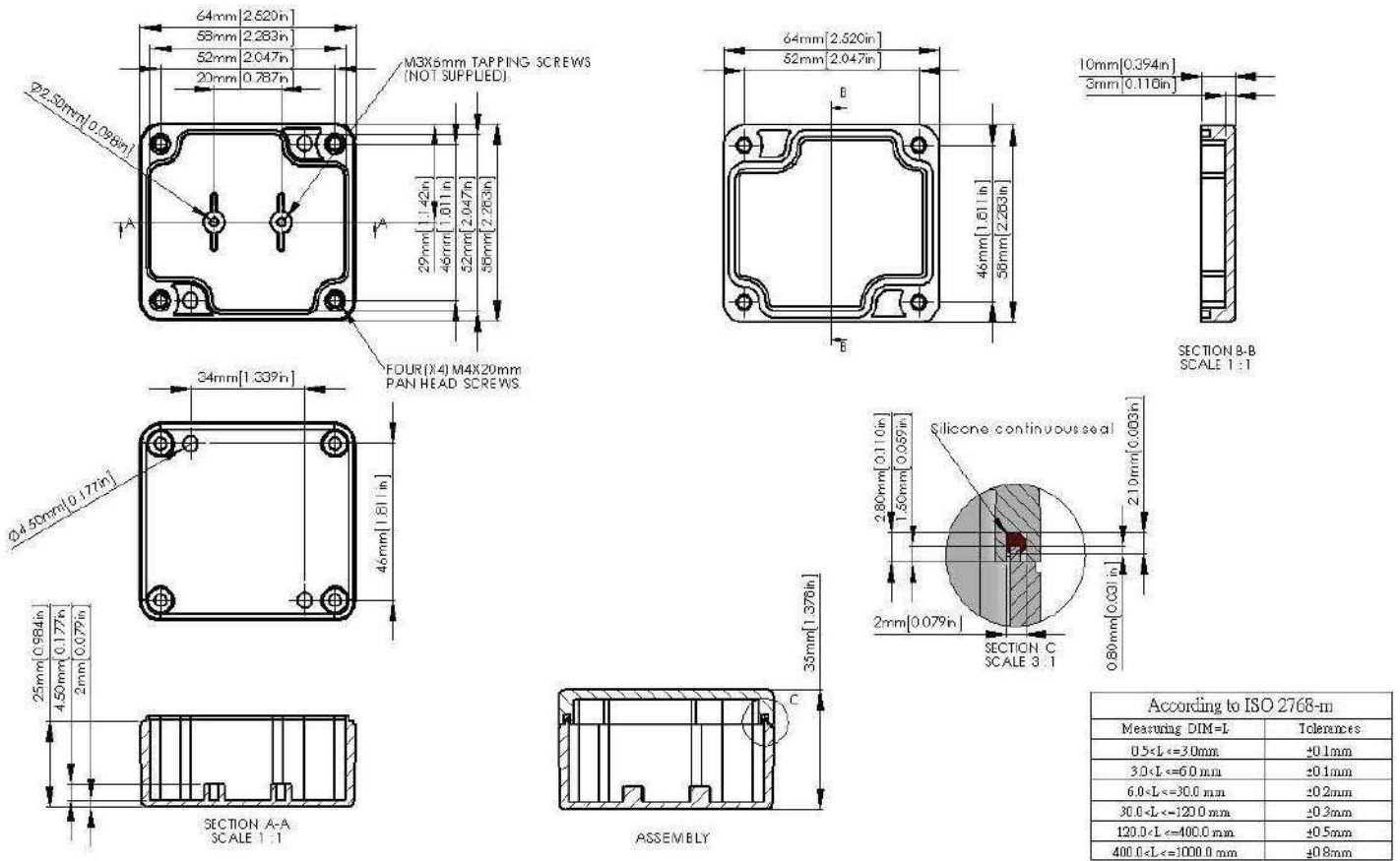

P203-IP68 / P203C-IP68 / A304-IP68

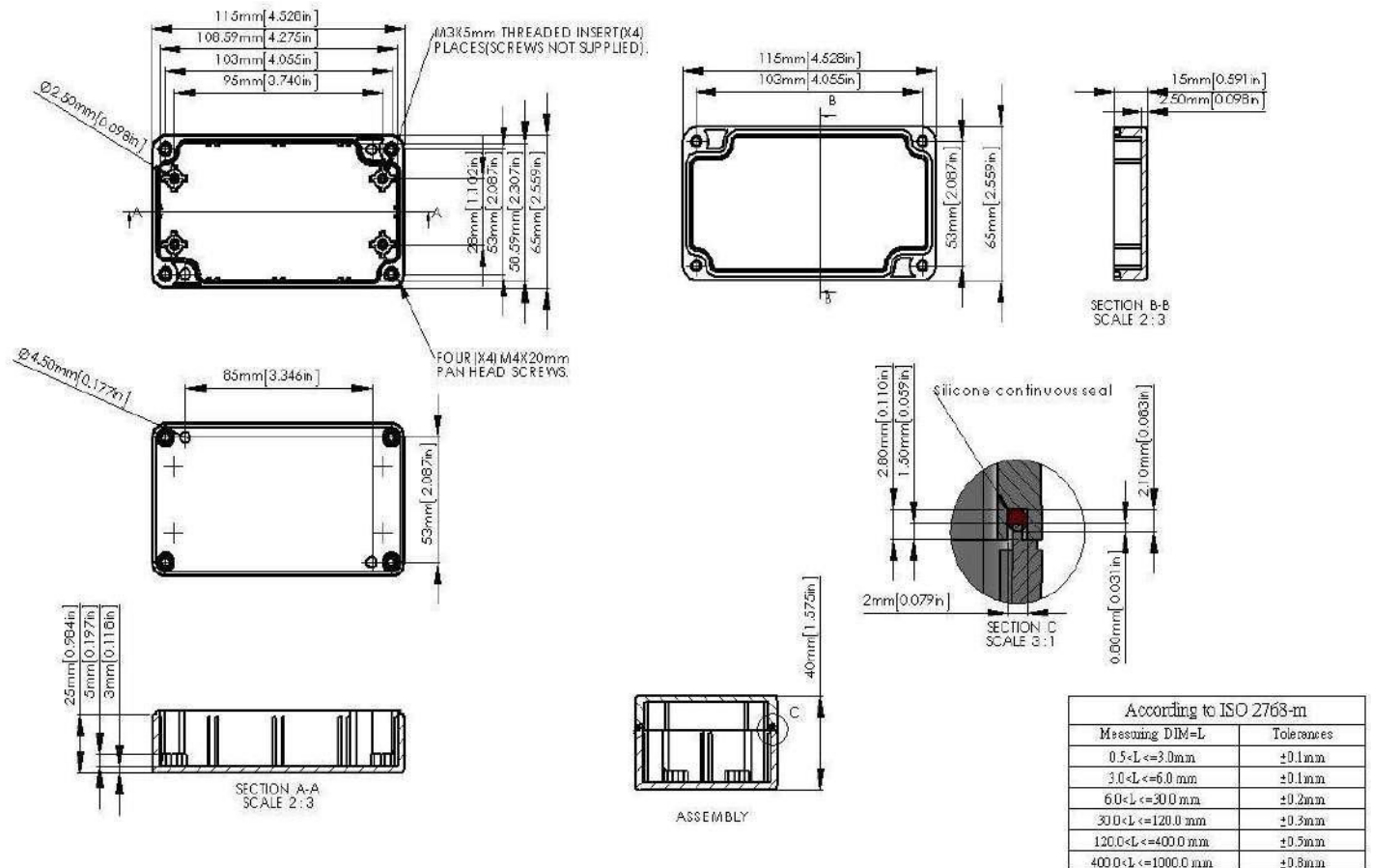

P205-IP68 / P205C-IP68 / A308-IP68

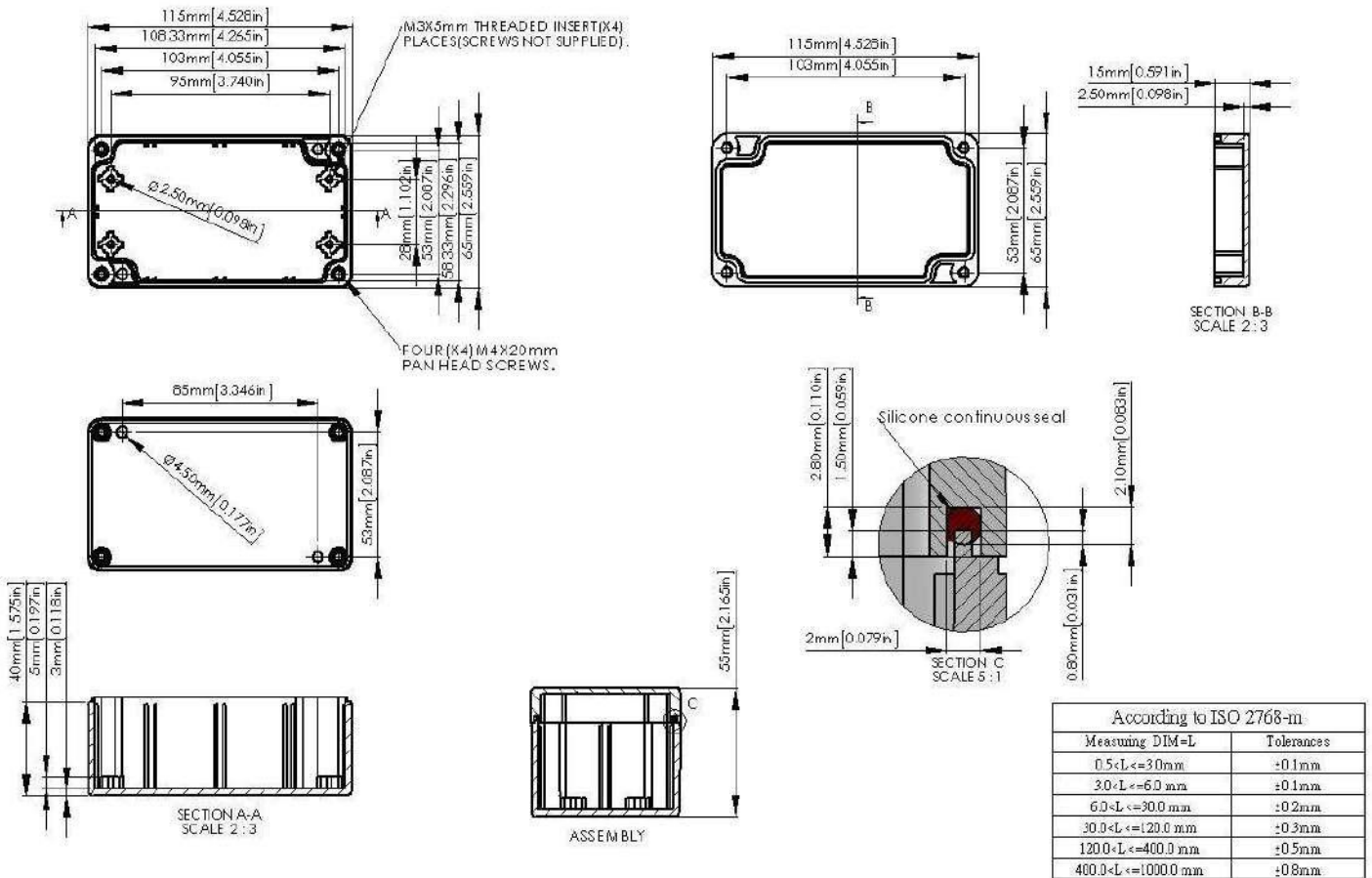

P212-IP68 / P212C-IP68 / A311-IP68

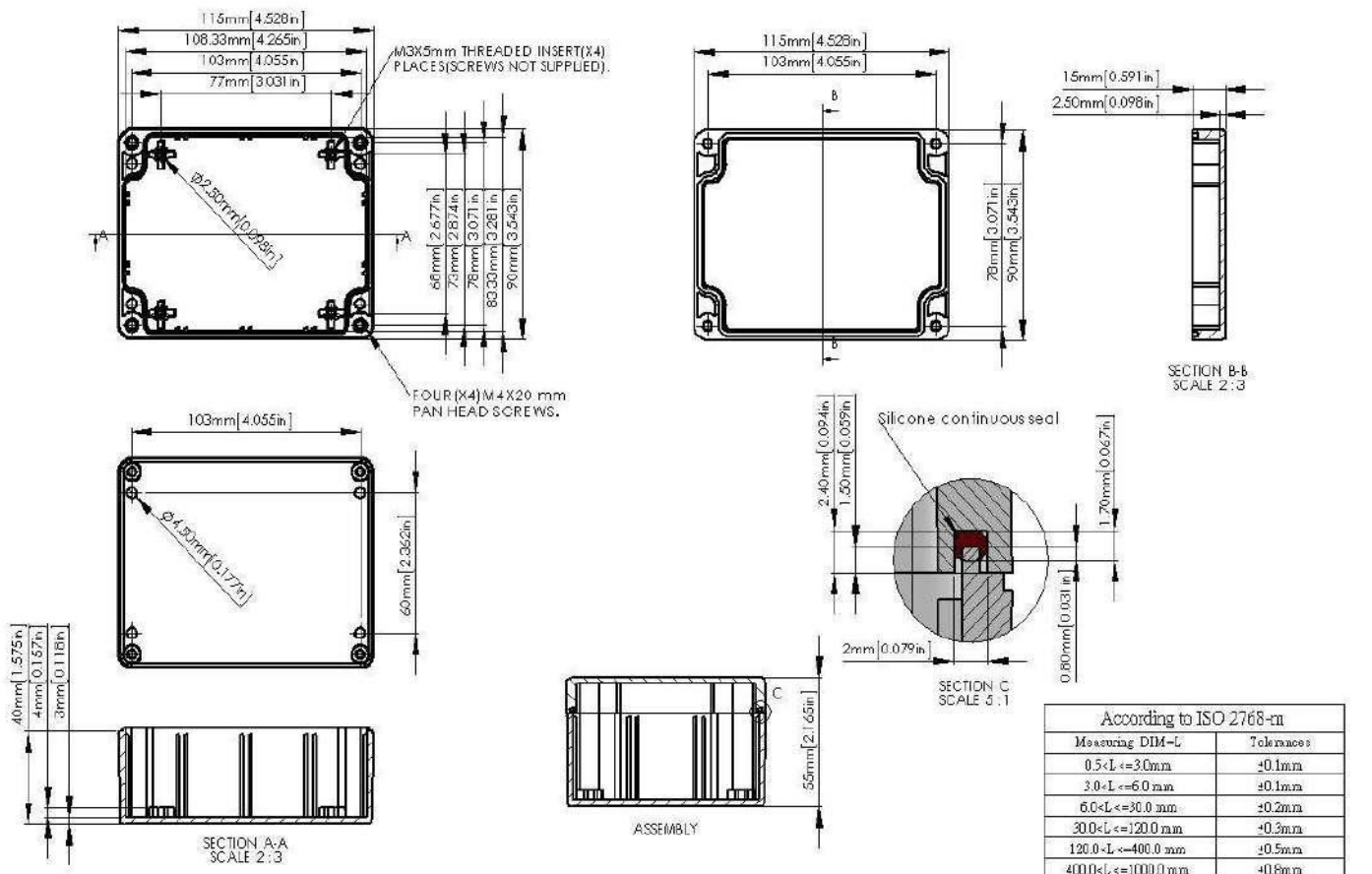

P214-IP68 / P214C-IP68 / A313-IP68

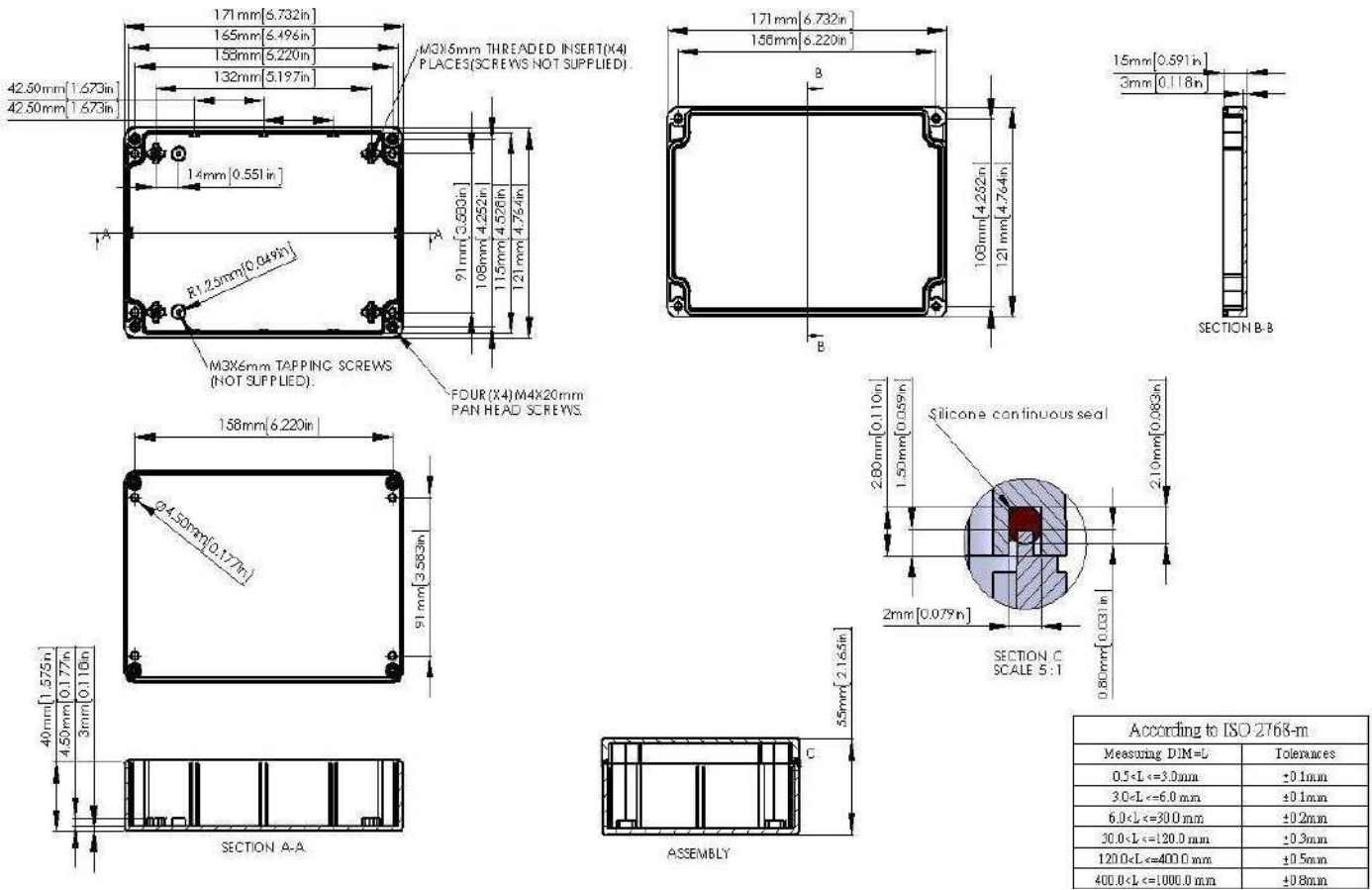

P218-IP68 / P218C-IP68 / A317-IP68

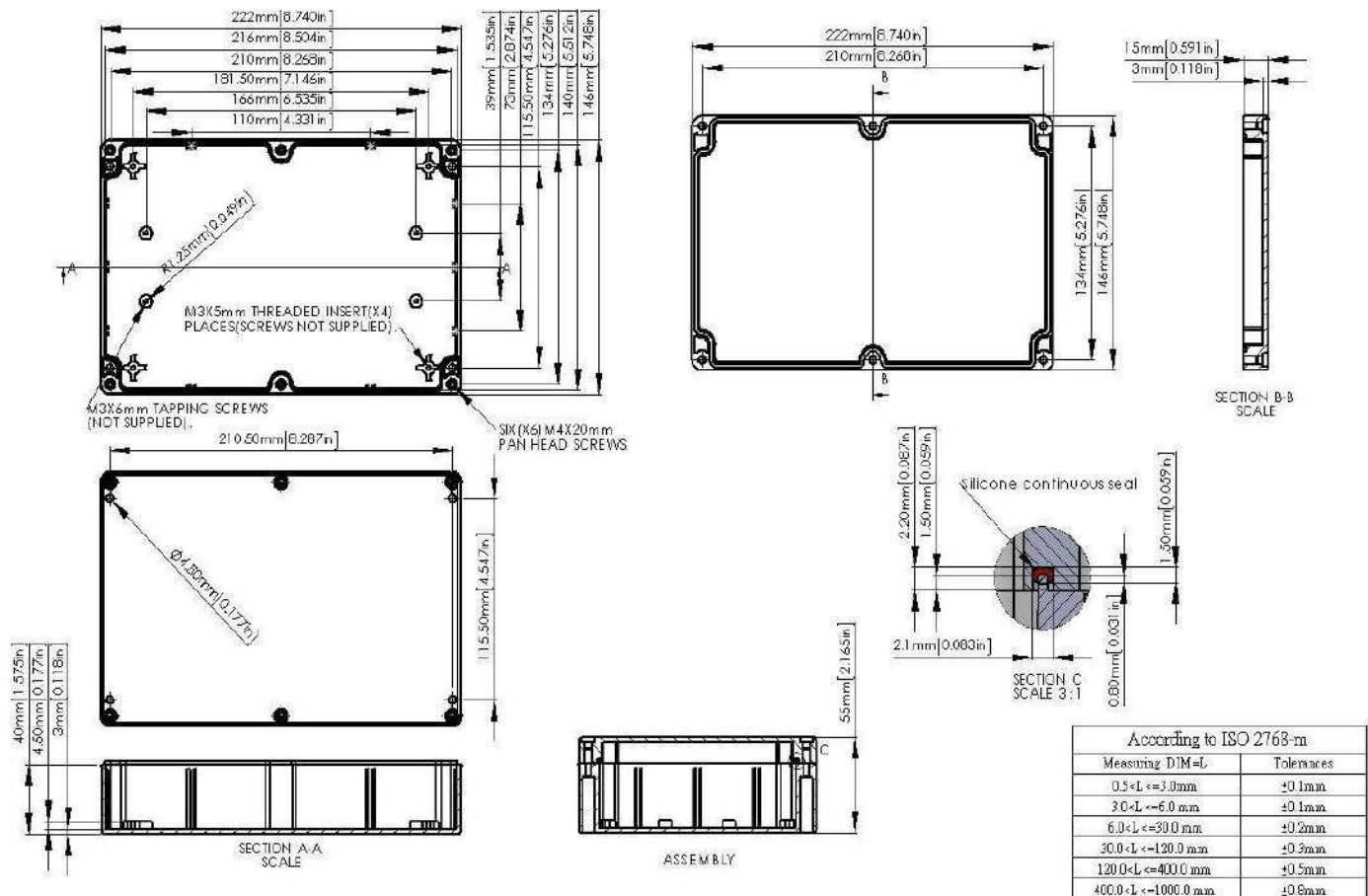

P221-IP68 / P221C-IP68 / A331-IP68

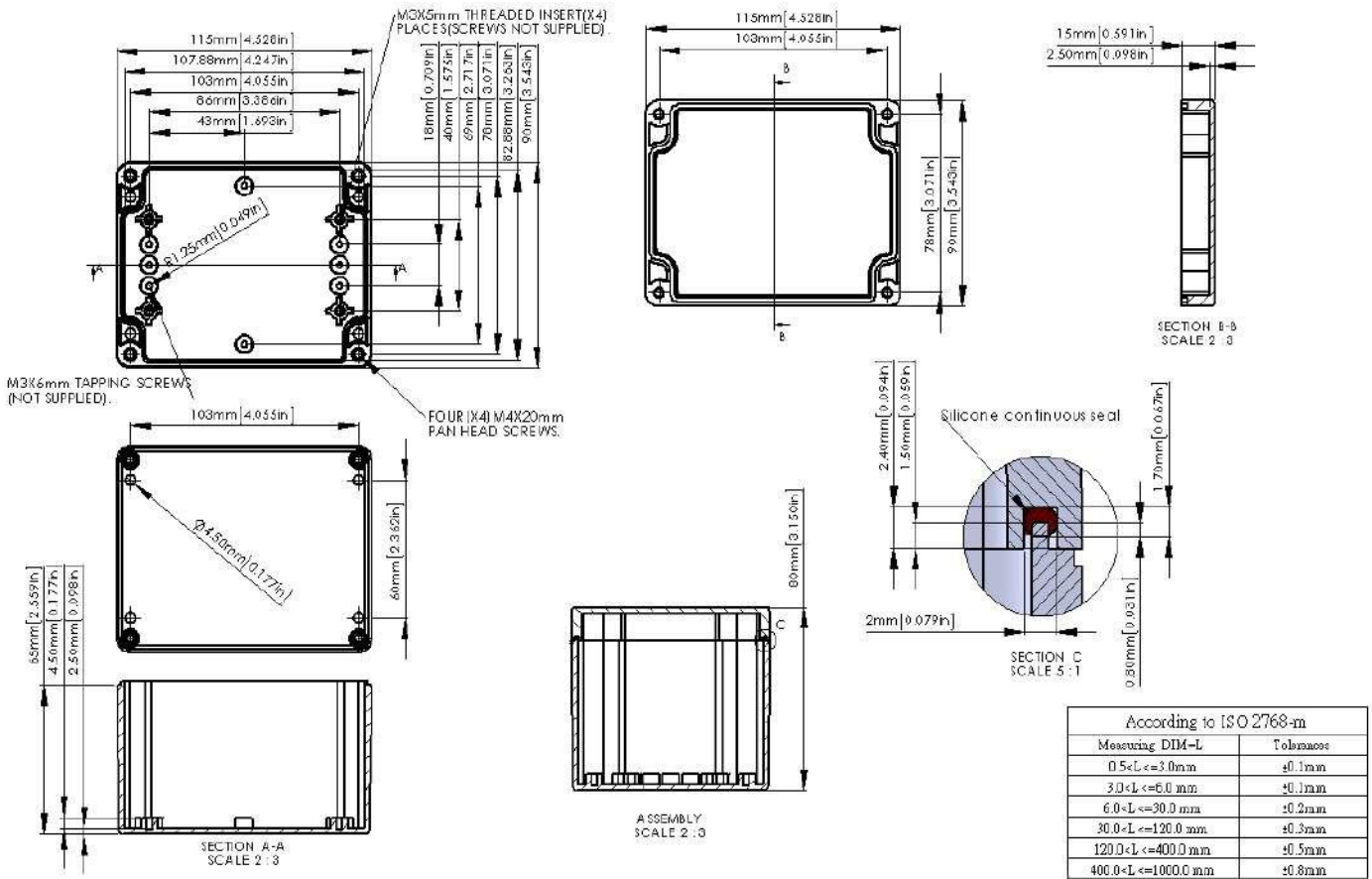

P223-IP68 / P223C-IP68 / A340-IP68

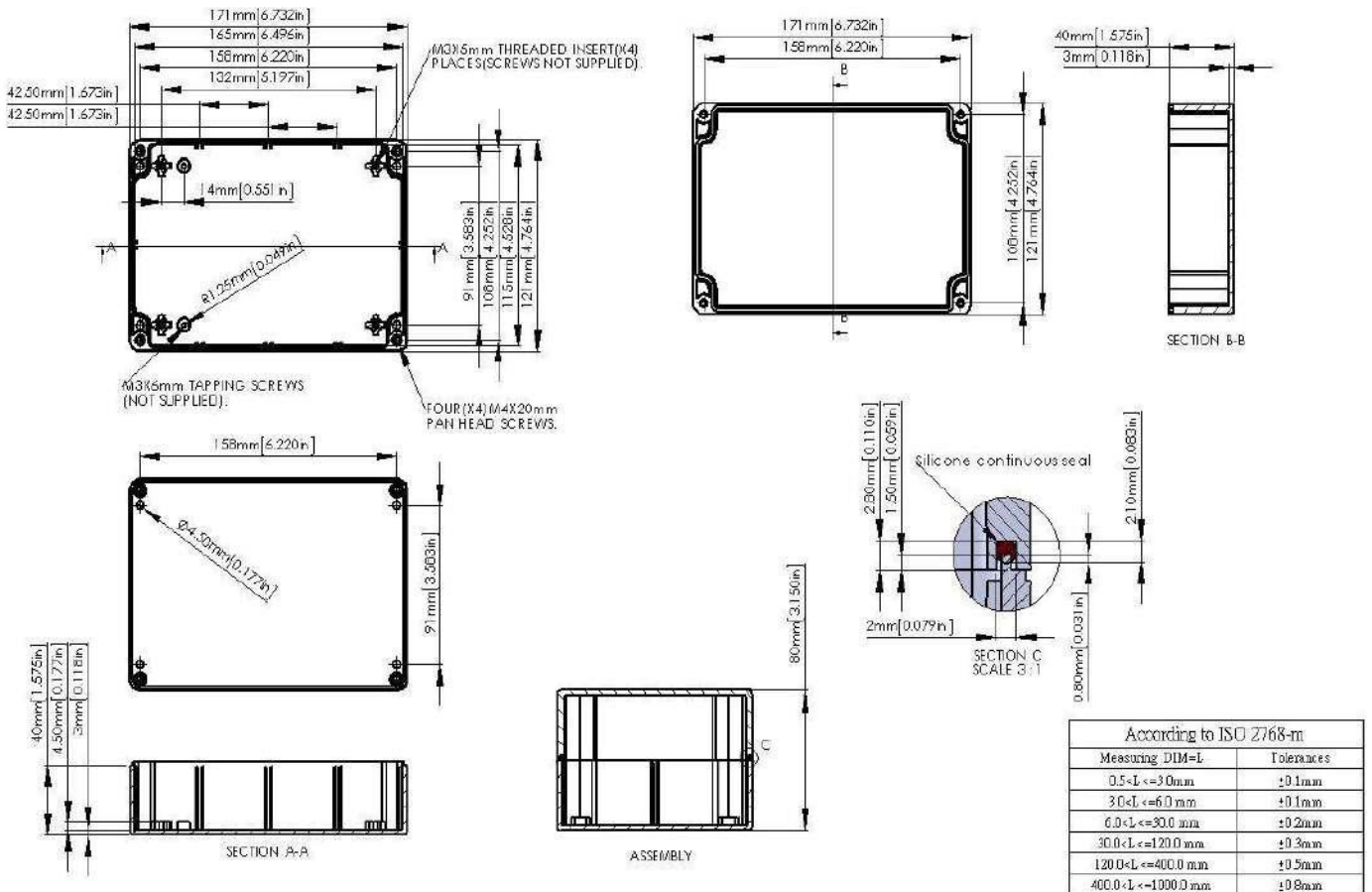

P229-IP68 / P229C-IP68 / A346-IP68

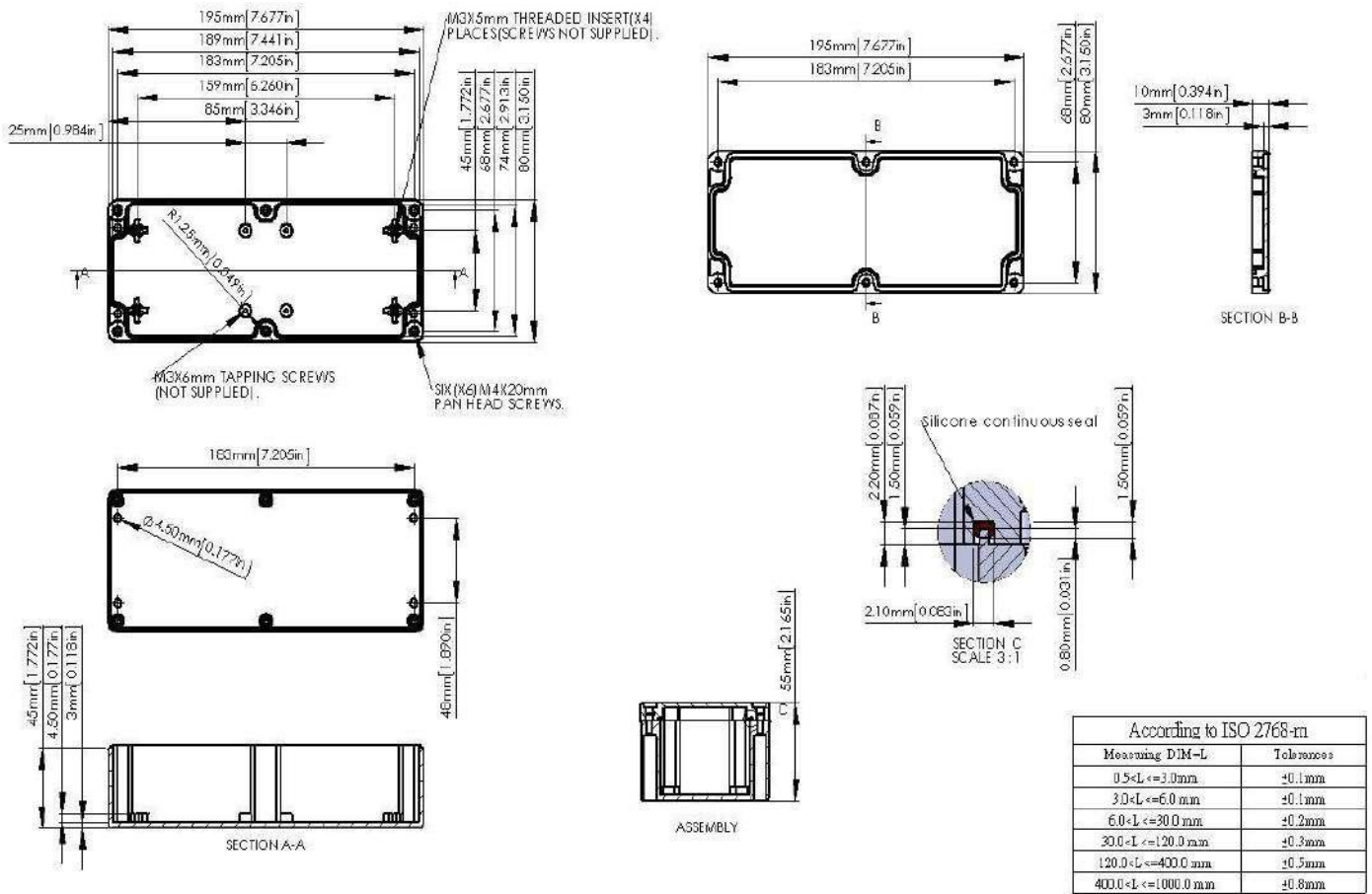

P232-IP68 / P232C-IP68 / A353-IP68

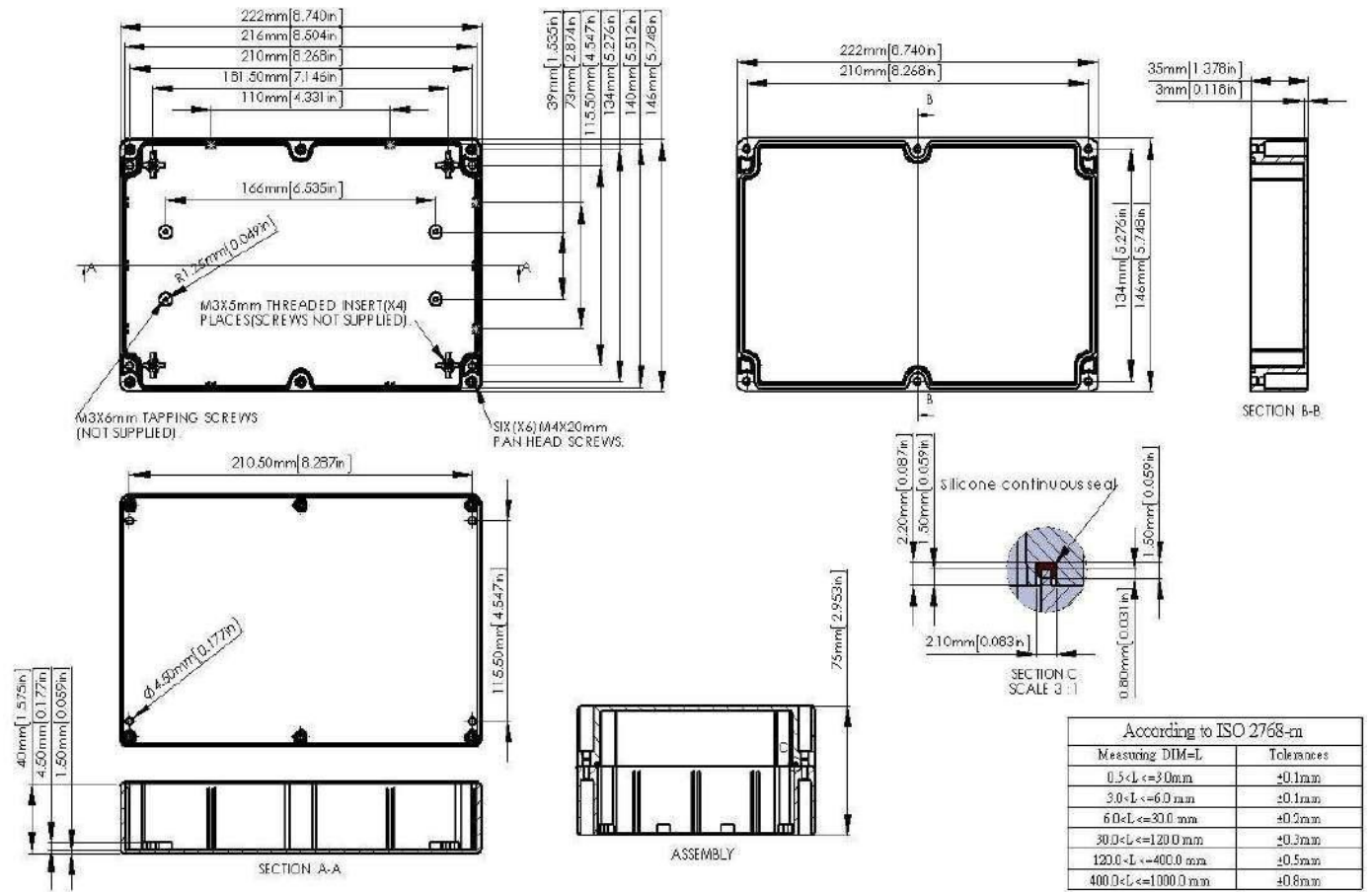

P250-IP68 / P250C-IP68 / A362-IP68

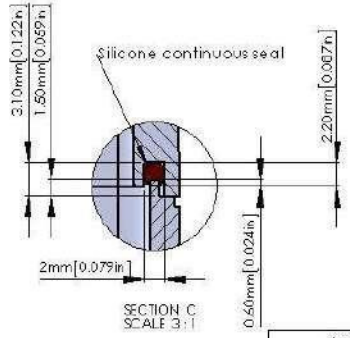
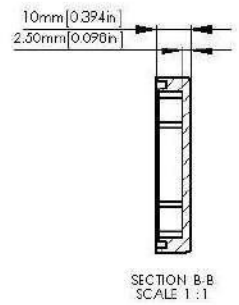
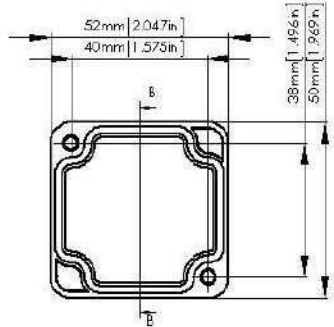
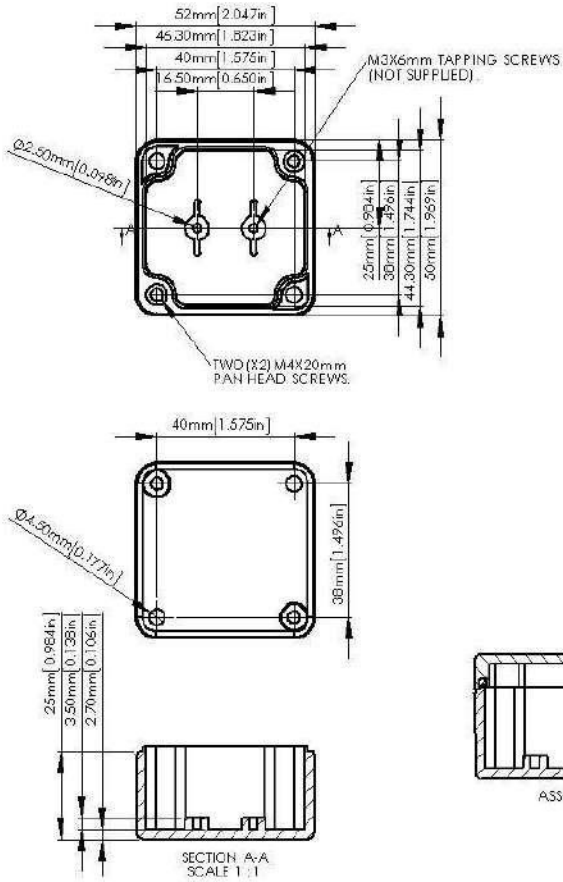

According to ISO 2768-m

Measuring DIM=L	Tolerances
0.5 <L <= 3.0 mm	±0.1 mm
3.0 <L <= 6.0 mm	±0.1 mm
6.0 <L <= 30.0 mm	±0.2 mm
30.0 <L <= 120.0 mm	±0.3 mm
120.0 <L <= 400.0 mm	±0.5 mm
400.0 <L <= 1000.0 mm	±0.8 mm

P256-IP68 / P256C-IP68 / A366-IP68

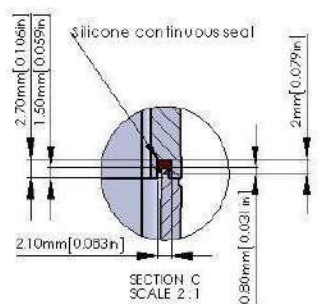
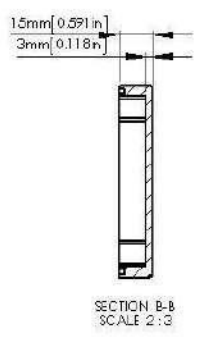
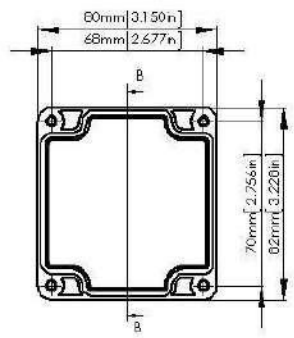
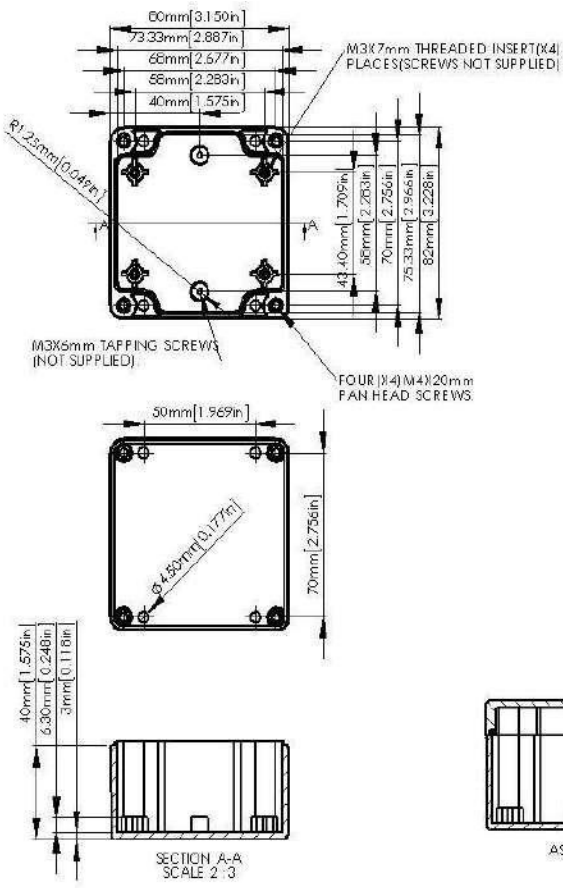

According to ISO 2768-m

Measuring DIM=L	Tolerances
0.5 <L <= 3.0 mm	±0.1 mm
3.0 <L <= 6.0 mm	±0.1 mm
6.0 <L <= 30.0 mm	±0.2 mm
30.0 <L <= 120.0 mm	±0.3 mm
120.0 <L <= 400.0 mm	±0.5 mm
400.0 <L <= 1000.0 mm	±0.8 mm

P258-IP68 / P258C-IP68 / A368-IP68

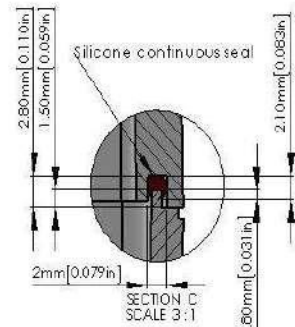
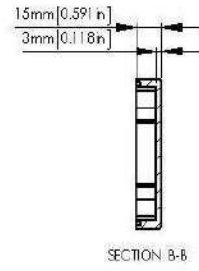
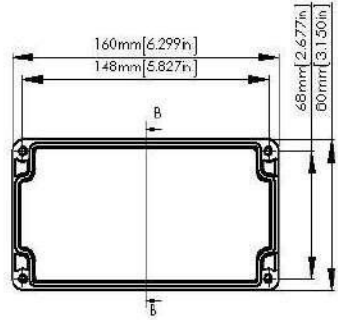
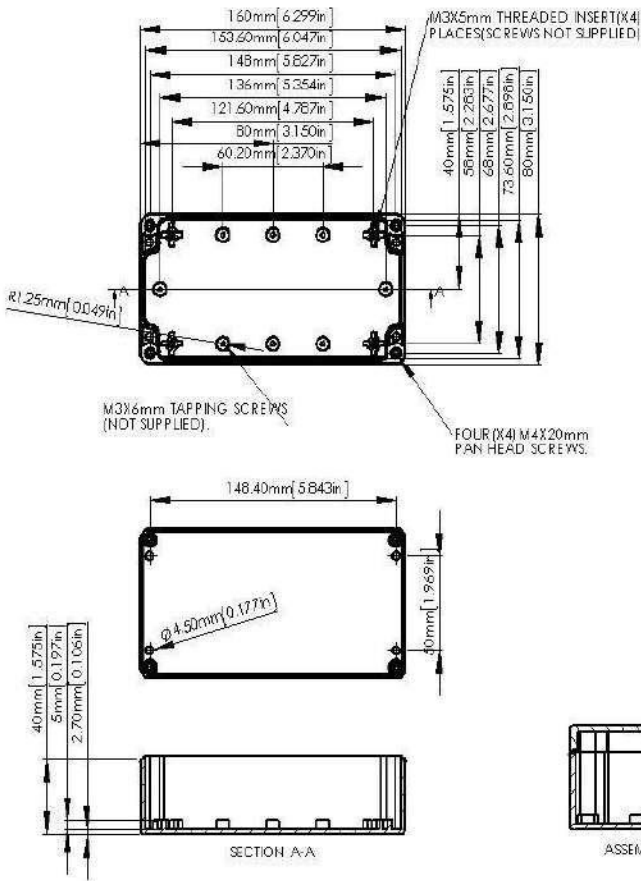

According to ISO 2768-m

Measuring DIM-L	Tolerances
0.5 < L ≤ 3.0 mm	±0.1 mm
3.0 < L ≤ 6.0 mm	±0.1 mm
6.0 < L ≤ 30.0 mm	±0.2 mm
30.0 < L ≤ 120.0 mm	±0.3 mm
120.0 < L ≤ 400.0 mm	±0.5 mm
400.0 < L ≤ 1000.0 mm	±0.8 mm

P265-IP68 / P265C-IP68 / A369-IP68

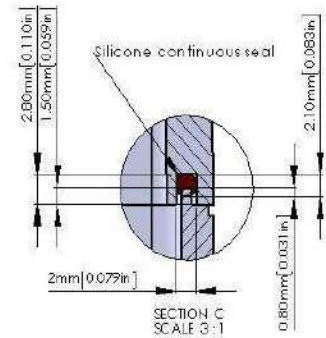
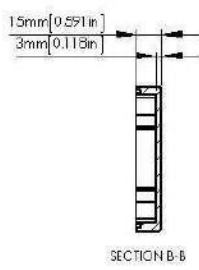
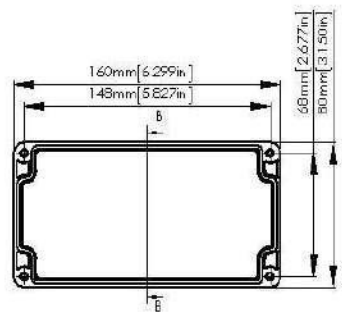
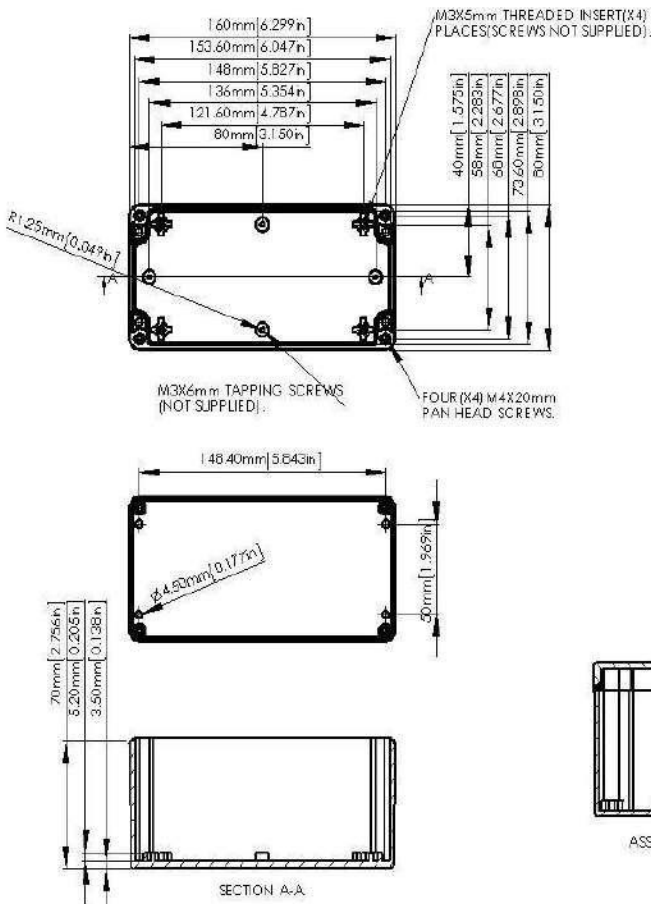

According to ISO 2768-m

Measuring DIM-L	Tolerances
0.5 < L ≤ 3.0 mm	±0.1 mm
3.0 < L ≤ 6.0 mm	±0.1 mm
6.0 < L ≤ 30.0 mm	±0.2 mm
30.0 < L ≤ 120.0 mm	±0.3 mm
120.0 < L ≤ 400.0 mm	±0.5 mm
400.0 < L ≤ 1000.0 mm	±0.8 mm

P278-IP68 / P278C-IP68 / A386-IP68

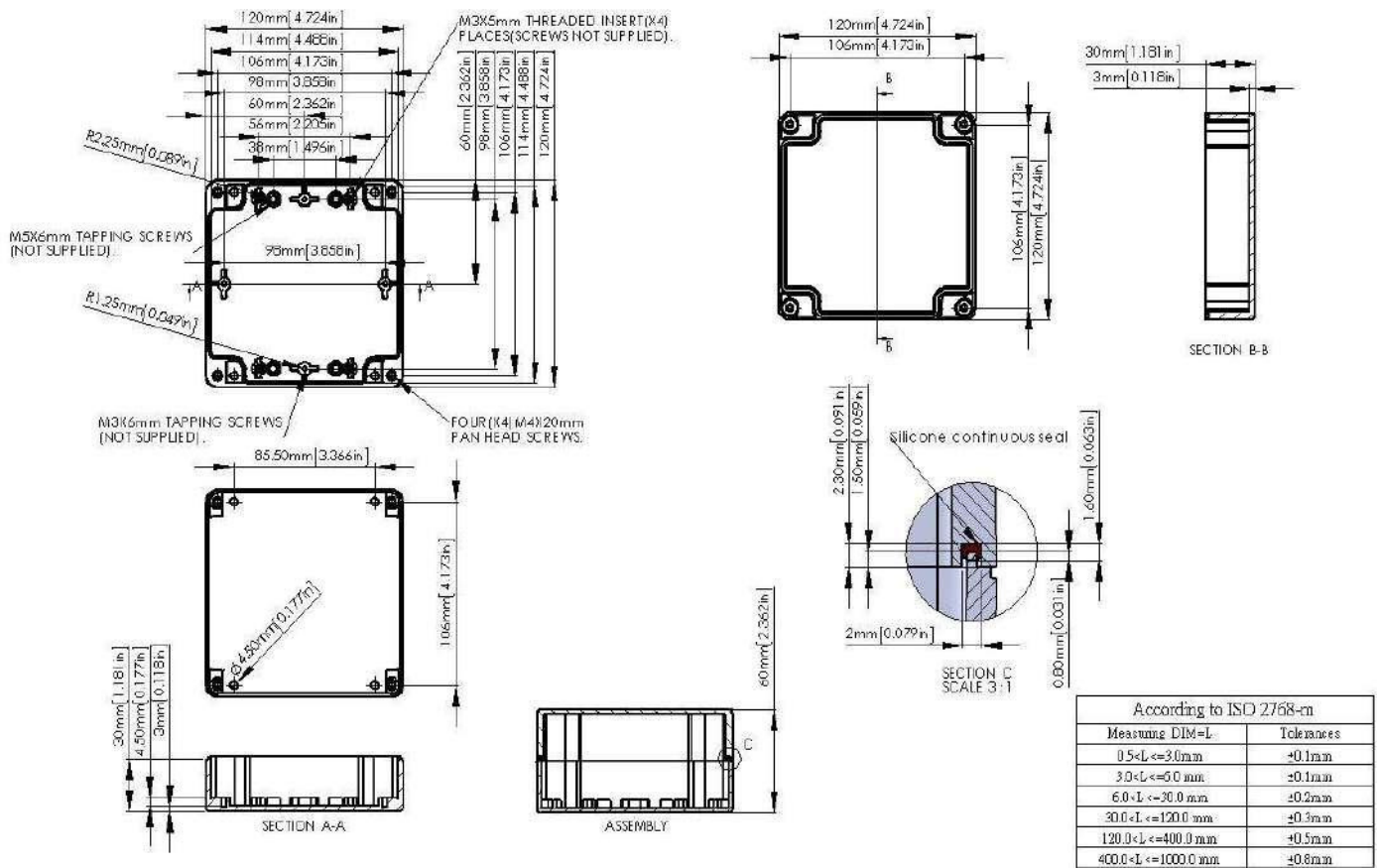

P279-IP68 / P279C-IP68 / A387-IP68

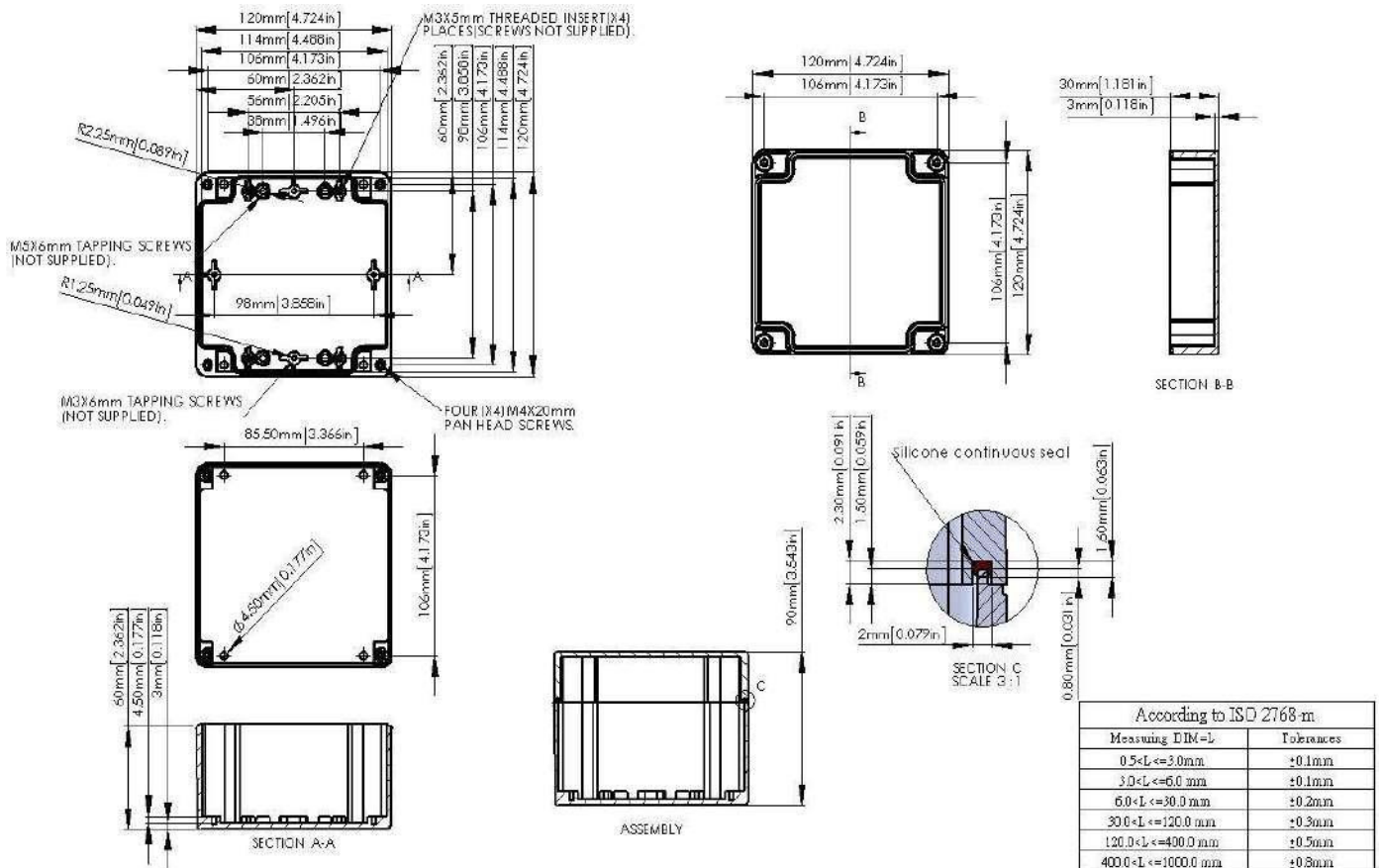

P287-IP68 / P287C-IP68 / A396-IP68

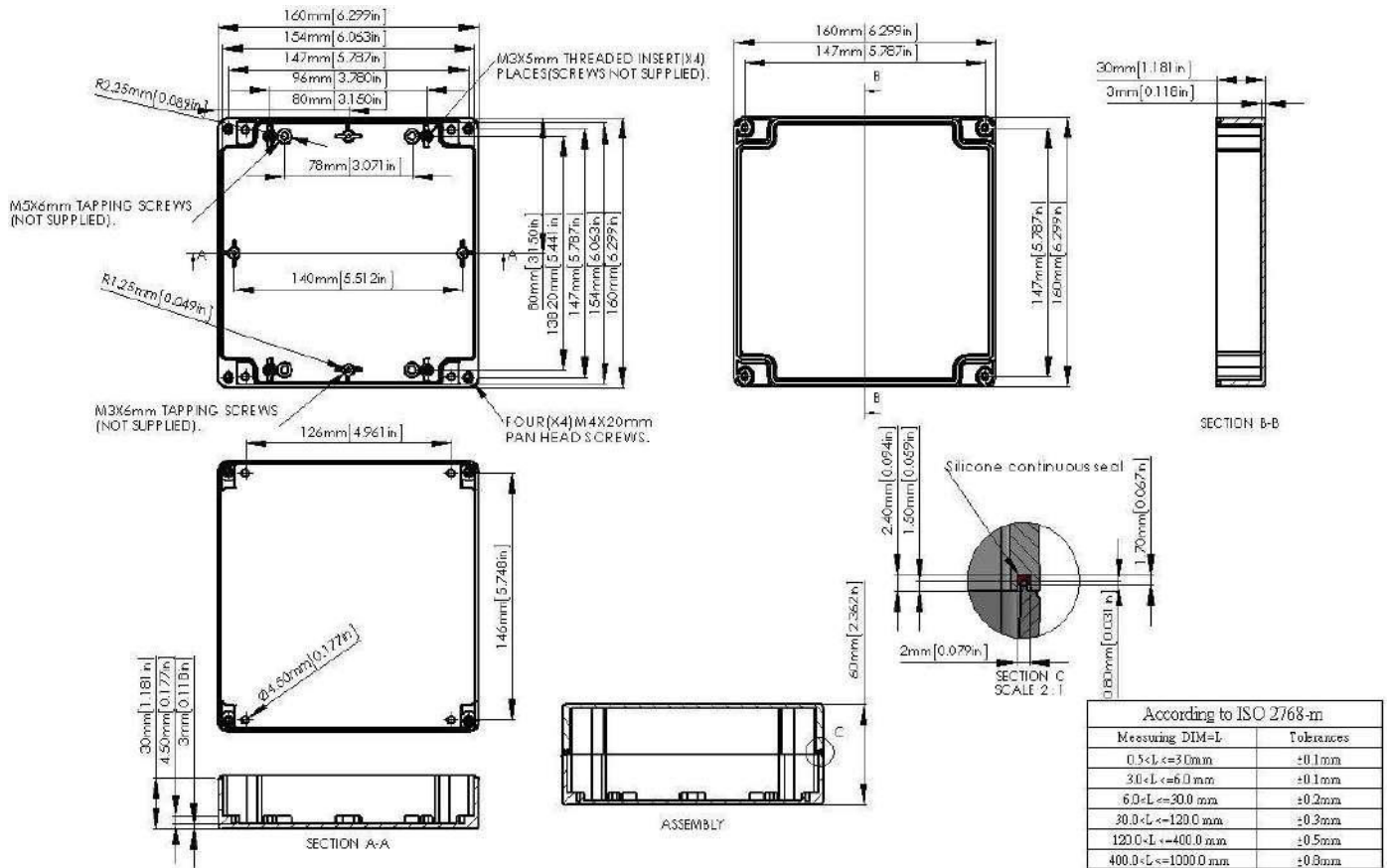

P288-IP68 / P288C-IP68 / A399-IP68

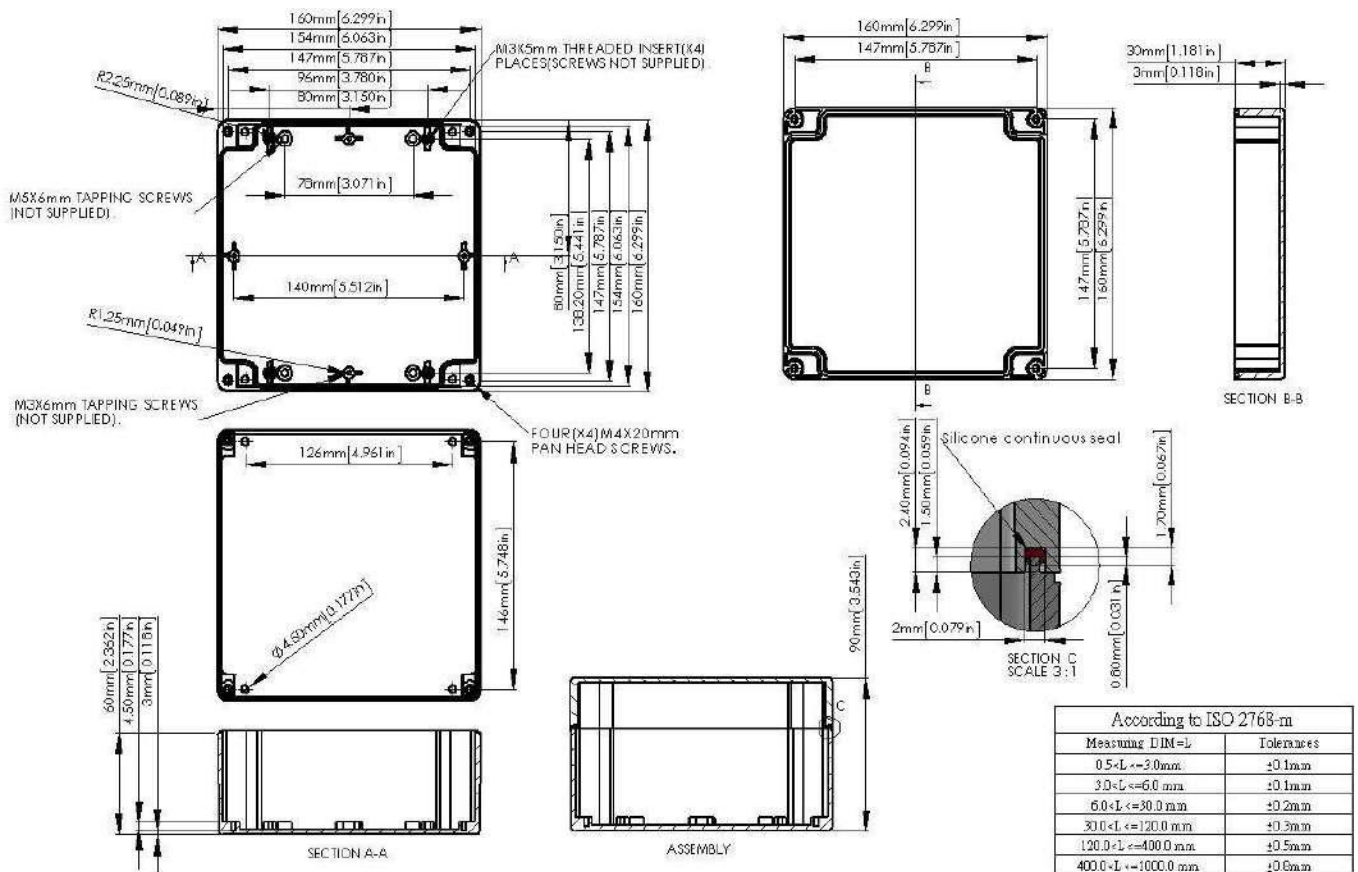

P2691-IP68 / P2691C-IP68 / A3735-IP68

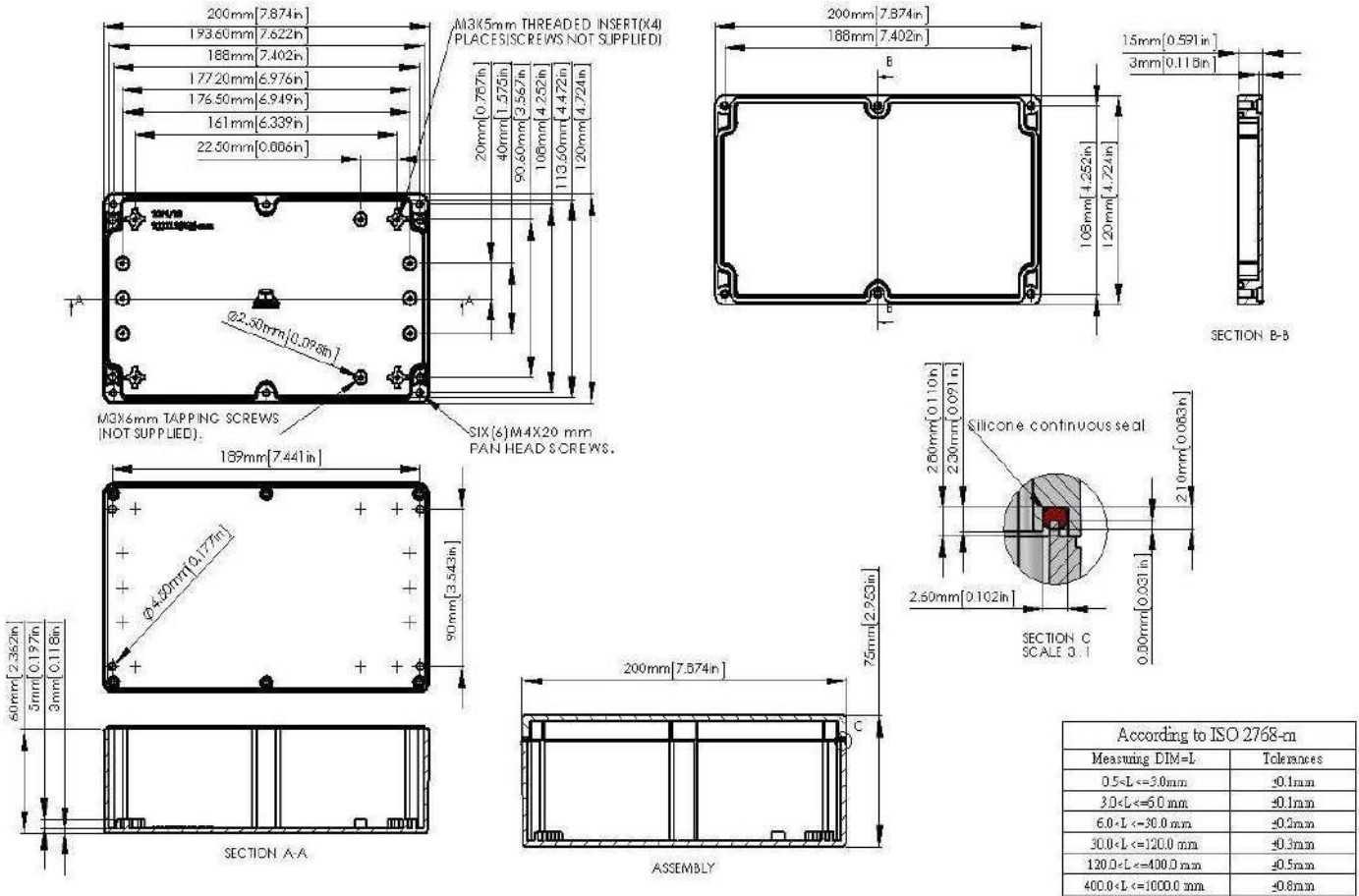

P2385-IP68 / P2385C-IP68 / A3783-IP68

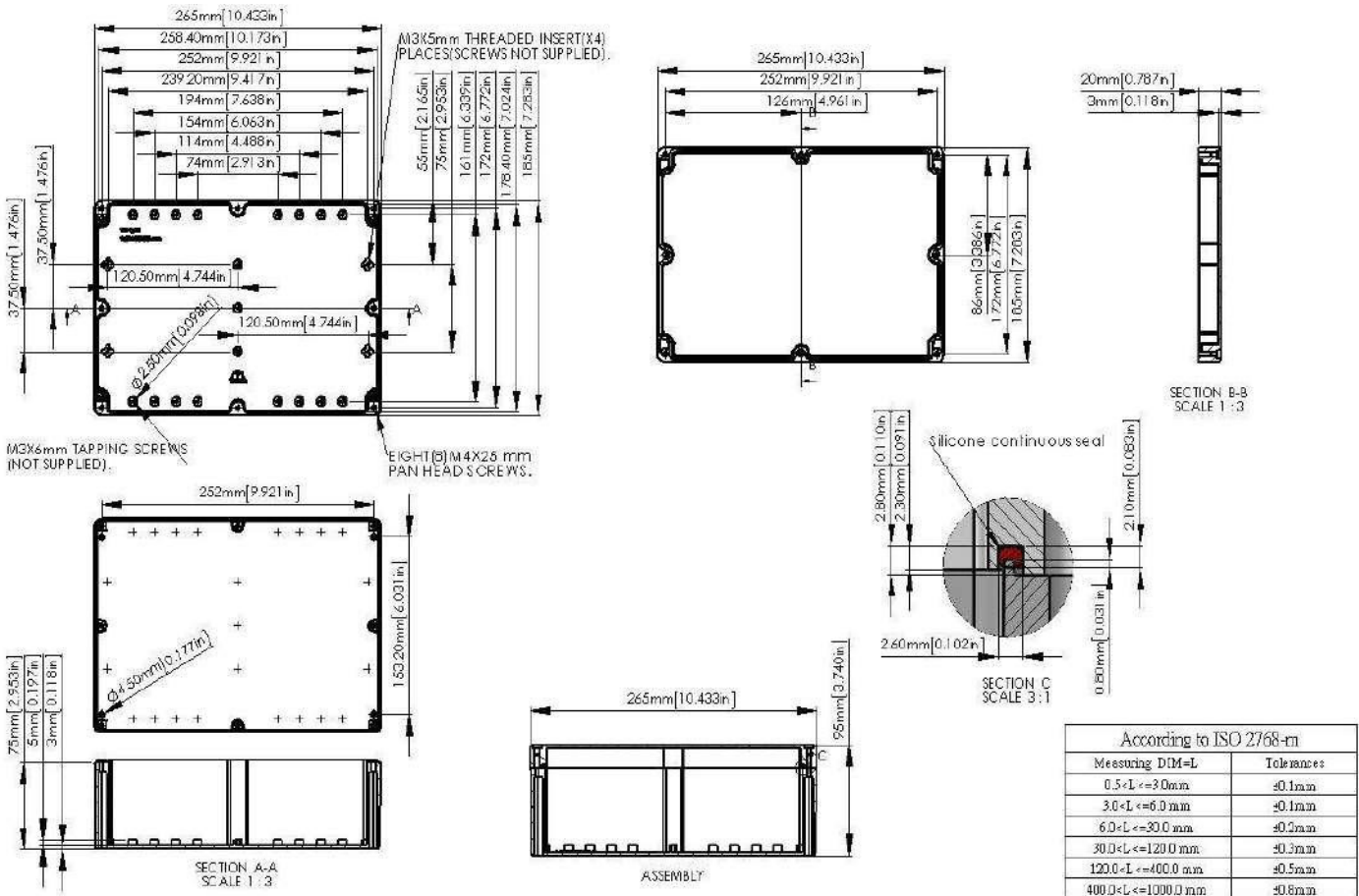

P2018-IP68 / P2018C-IP68 / A3008-IP68

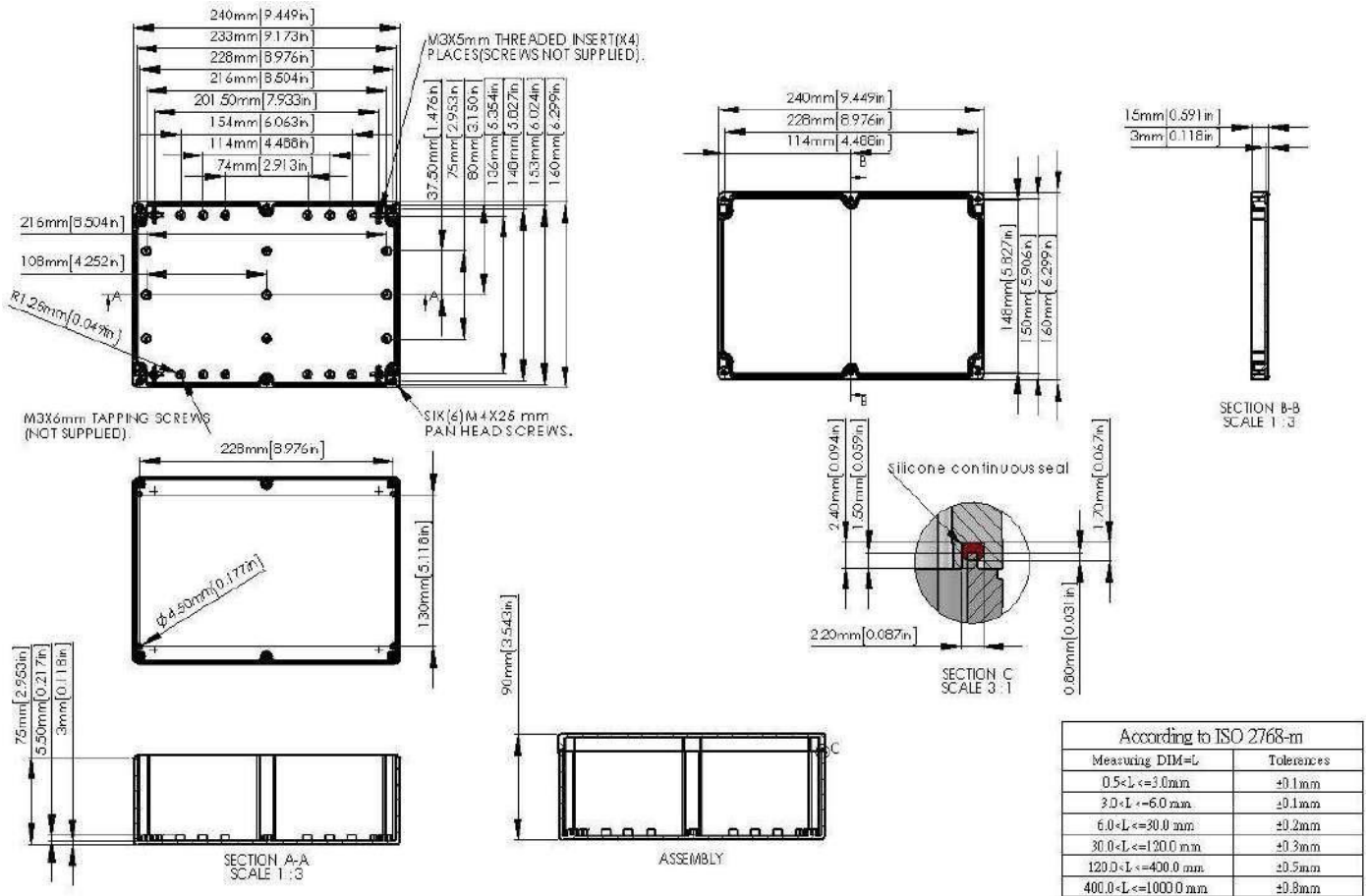

P2025-IP68 / P2025C-IP68 / A3019-IP68

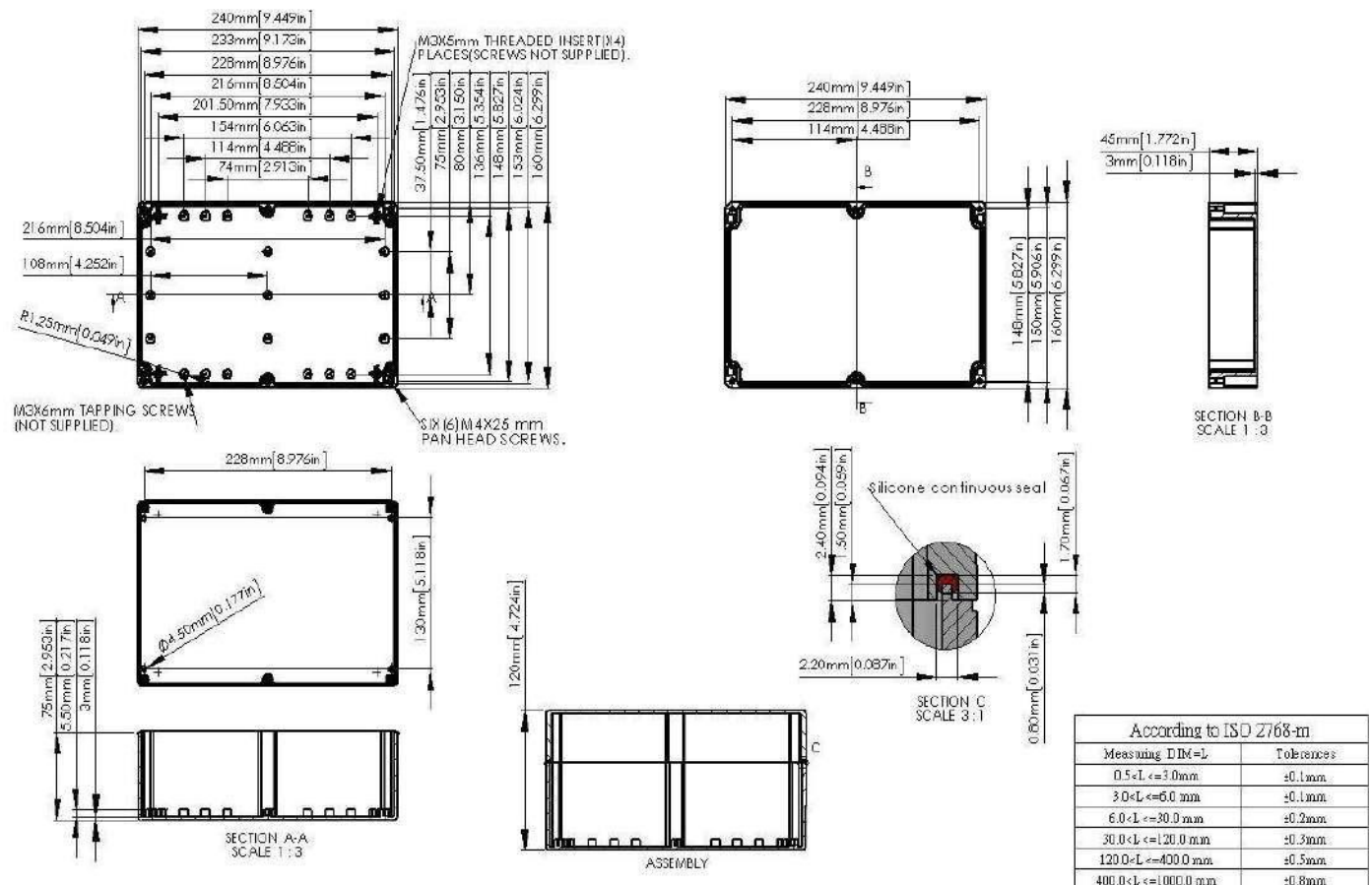

P20295-IP68 / P20295C-IP68 / A30285-IP68

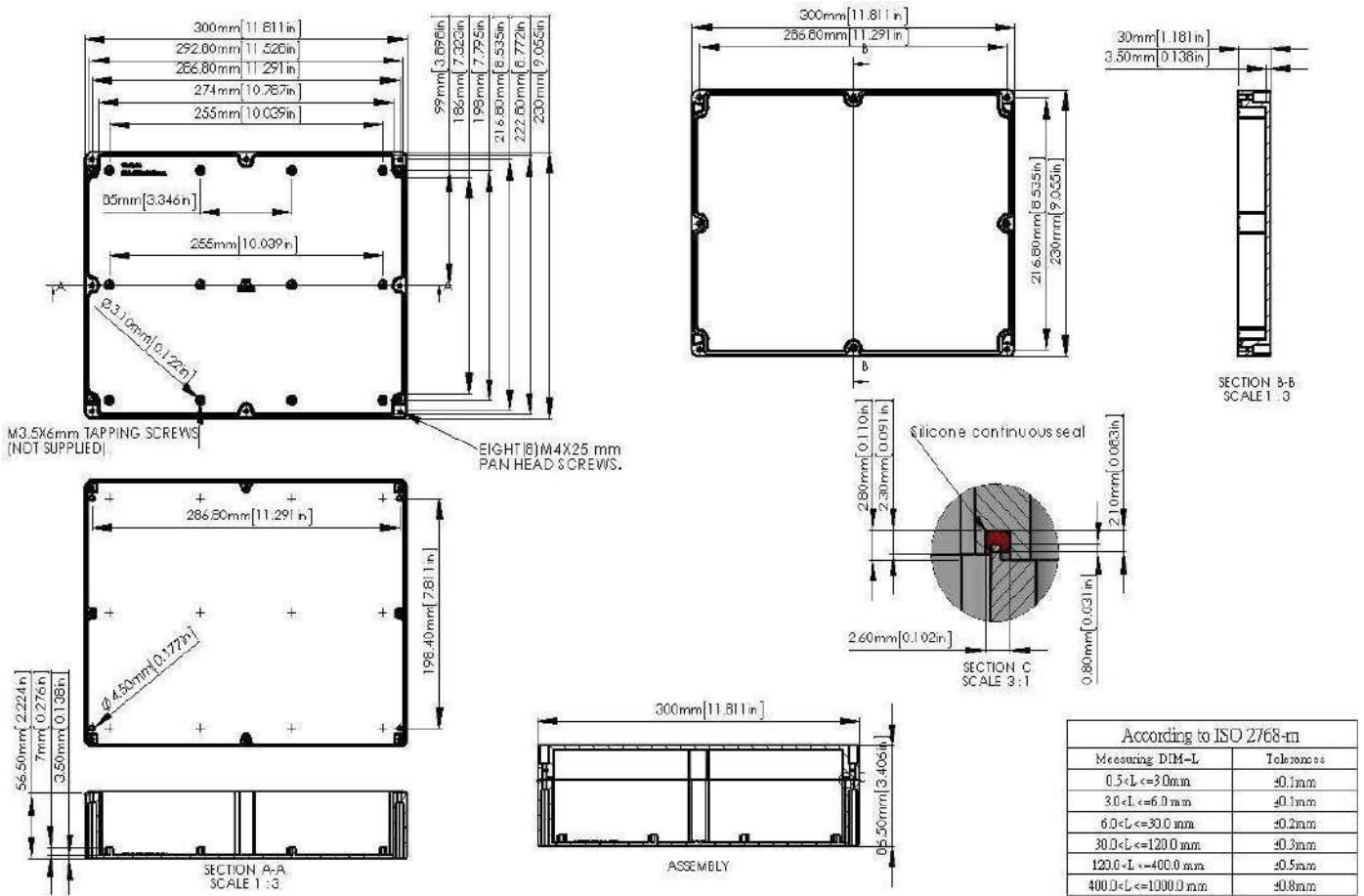

P20385-IP68 / P20385C-IP68 / A30312-IP68

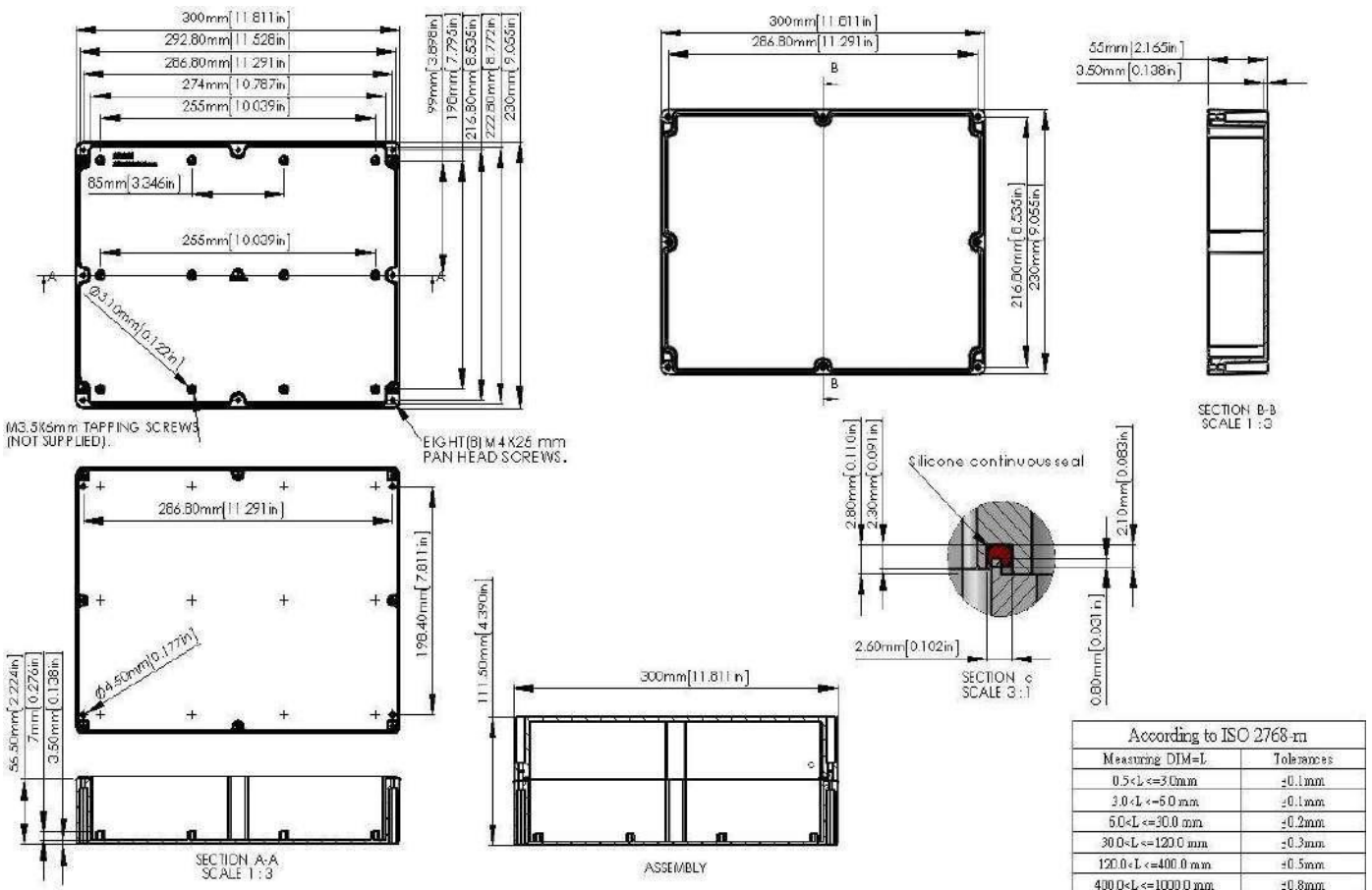

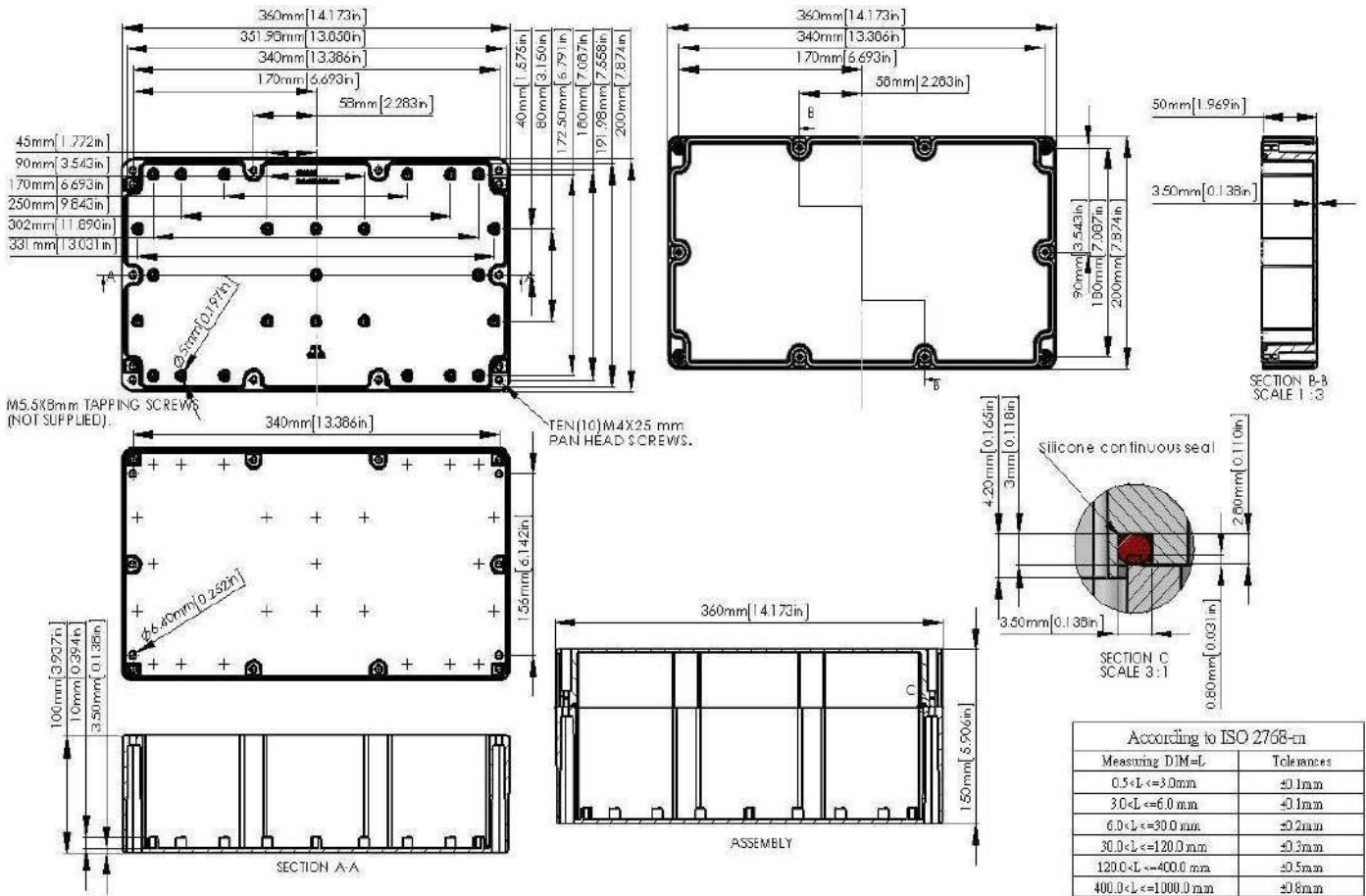

According to ISO 2768-m

Measuring DIM=L	Tolerances
0.5<L<=3.0mm	±0.1mm
3.0<L<=6.0 mm	±0.1mm
6.0<L<=30.0 mm	±0.2mm
30.0<L<=120.0 mm	±0.3mm
120.0<L<=400.0 mm	±0.5mm
400.0<L<=1000.0 mm	±0.8mm