

# WIN PRO+ 30 A/M

Part number 3116166

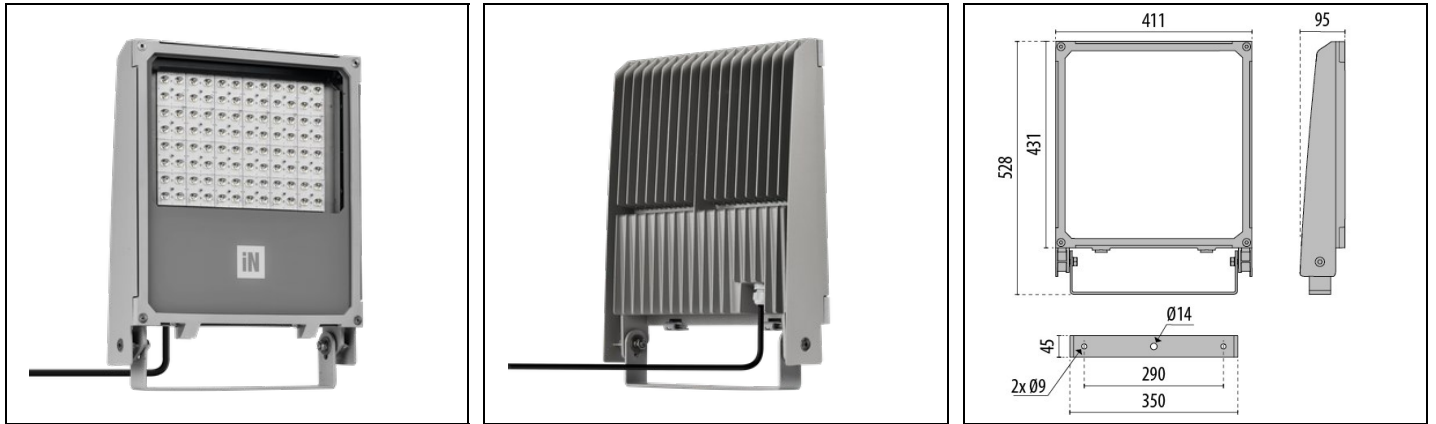

## Description

LED floodlight for indoor and outdoor, comprising:

- Die-cast aluminium housing, polyester powder coat finish ISO 9227/12944 - ISO 9223 (C5)
- Extra clear, toughened, flat glass diffuser
- High-transparency polycarbonate optics
- Anti-ageing custom moulded silicone sealing gasket(s) with resilient elastic return capacity
- Coated die-cast aluminium captive trim, hinged to the housing
- Cable gland M20x1.5 for cables Ø 10- Ø 14 mm
- Complete with 1 m factory pre-wired cable H07RN-F 3G1.5 mm<sup>2</sup>
- Stainless steel locking hardware
- Powder-coated steel tiltable bracket
- Integral surge protection device (SPD) against mains overvoltages up to 10 kV (CM/DM)
- Openable and maintainable luminaire (future-proof)
- Other colour temperatures (CCT) and colour rendering index (CRI) options available. Consult factory

## Product data

|             |          |             |          |
|-------------|----------|-------------|----------|
| ETIM Group: | EG000027 | ETIM Class: | EC001744 |
|-------------|----------|-------------|----------|

## General information

|                                |                                  |                              |       |
|--------------------------------|----------------------------------|------------------------------|-------|
| Lampholder:                    | LED                              | Light source:                | LED   |
| Lightsource lumen output [lm]: | 40613                            | Luminaire lumen output [lm]: | 35834 |
| Luminaire wattage [W]:         | 252 W                            | Luminous efficacy [lm/W]:    | 142   |
| CRI:                           | 70                               | Colour temperature [K]:      | 3000  |
| Colour / Finishing:            | GR-94 / Metallic grey / Textured | IP degree of protection:     | IP66  |
| IK-J-xxIP:                     | IK08 5J xx5                      | Protection class:            | I     |
| Optic:                         | Asymmetric Medium                | Net weight [kg]:             | 9.833 |
| Overall length [mm]:           | 411                              | Overall width [mm]:          | 528   |
| Overall height [mm]:           | 95                               |                              |       |

## Mechanical features

|   |             |   |           |
|---|-------------|---|-----------|
| Shape:                                  | Rectangular | Housing material:                       | Aluminium |
| Diffuser material:                      | Glass       | Glow wire test [°C]:                    | 650 °C    |
| Frontal exposed area [m <sup>2</sup> ]: | 0.03        | Lateral exposed area [m <sup>2</sup> ]: | 0.04      |
| Top exposed area [m <sup>2</sup> ]:     | 0.18        |   |           |

## Electrical features

|                                       |         |                                 |          |
|---------------------------------------|---------|---------------------------------|----------|
| Voltage type:                         | AC/DC   | Input voltage [V AC]:           | 220/240  |
| Input frequency [Hz]:                 | 0/50/60 | Power factor / COS Φ:           | >0.9     |
| Input voltage [V DC]:                 | 176/276 | Surge protection   Common [kV]: | 10.0     |
| Surge protection   Differential [kV]: | 10.0    | Inrush current [A/μs]:          | 7 / 1180 |
| C10 1.5 mm <sup>2</sup> :             | 5       | C16 2.5 mm <sup>2</sup> :       | 9        |
| B10 1.5 mm <sup>2</sup> :             | 5       | B16 2.5 mm <sup>2</sup> :       | 9        |

## Installation

|  |         |                                |               |
|--|---------|--------------------------------|---------------|
| Application area:                      | Outdoor | Mounting type:                 | Floodlighting |
| Min. ambient temperature [°C]:         | -40     | Max. ambient temperature [°C]: | 40            |
| Min. distance from lighted object [m]: | 0.50    |                                |               |

## Light features

|                                   |        |                           |                |
|-----------------------------------|--------|---------------------------|----------------|
| MacAdam:                          | 3      | Lumen maintenance:        | L80B10@200000h |
| Distribution of light emission:   | Direct | Luminous Intensity Class: | G*6            |
| Zero light pollution (ULR = 0%):  |        | IPEA* (road lighting):    | A3+            |
| IPEA* (large areas, roundabouts): | A8+    | IPEA* (cycle-pedestrian): | A4+            |

To maintain the regular updating of our products, PERFORMANCE iN LIGHTING reserves the right to make changes without prior notice. For the most up to date information we always recommend you read the latest version published on the website [www.performanceinlighting.com](http://www.performanceinlighting.com). Delivered luminaire lumen outputs and power consumptions, including losses, are subject to a tolerance of +/- 7%, and unless otherwise stated the values apply to an ambient temperature of 25°C. Terms of warranty are available at [www.performanceinlighting.com/qr/qr/company/terms-and-conditions](http://www.performanceinlighting.com/qr/qr/company/terms-and-conditions)

IPEA\* (green areas): A4+

---

IPEA\* (historic city centers): A9+

---

---

To maintain the regular updating of our products, PERFORMANCE iN LIGHTING reserves the right to make changes without prior notice. For the most up to date information we always recommend you read the latest version published on the website [www.performanceinlighting.com](http://www.performanceinlighting.com). Delivered luminaire lumen outputs and power consumptions, including losses, are subject to a tolerance of +/- 7%, and unless otherwise stated the values apply to an ambient temperature of 25°C. Terms of warranty are available at [www.performanceinlighting.com/qr/qr/company/terms-and-conditions](http://www.performanceinlighting.com/qr/qr/company/terms-and-conditions)

## Photometric data

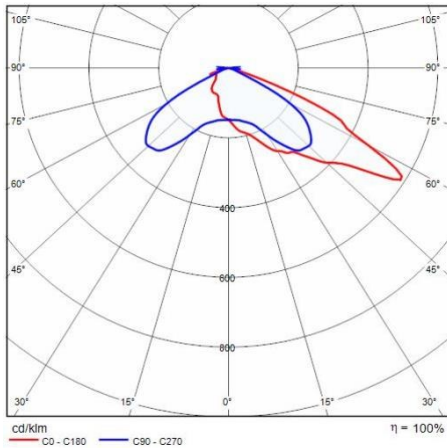

## Optional accessories

### WIN PRO 30

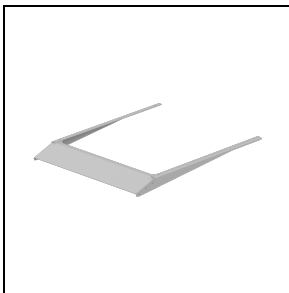

**3116517**

Louvre WIN PRO 30 - 5°

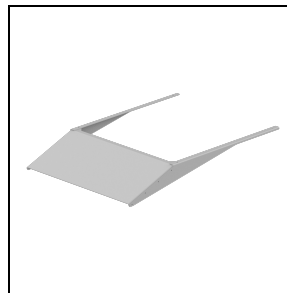

**3116518**

Louvre WIN PRO 30 - 10°

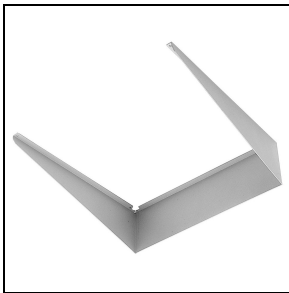

**14045794**

External steel cowl painted aluminium grey

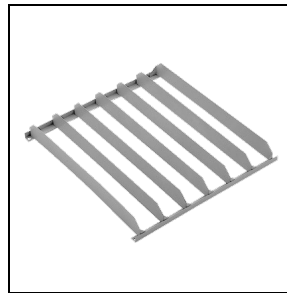

**14045694**

External anti-glare louvre painted aluminium grey



**3115887**

Connection Kit 5P Ø 8=17 mm - IP68

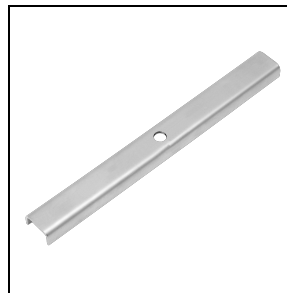

**14046120**

Strengthening bracket. Suitable for one floodlight single point fixing M12 screw in centre of the bracket

To maintain the regular updating of our products, PERFORMANCE iN LIGHTING reserves the right to make changes without prior notice. For the most up to date information we always recommend you read the latest version published on the website [www.performanceinlighting.com](http://www.performanceinlighting.com). Delivered luminaire lumen outputs and power consumptions, including losses, are subject to a tolerance of +/- 7%, and unless otherwise stated the values apply to an ambient temperature of 25°C. Terms of warranty are available at [www.performanceinlighting.com/qr/qr/company/terms-and-conditions](http://www.performanceinlighting.com/qr/qr/company/terms-and-conditions)



**14051294**  
Single pole top mounting, for Ø 60-76 mm poles, painted aluminium grey

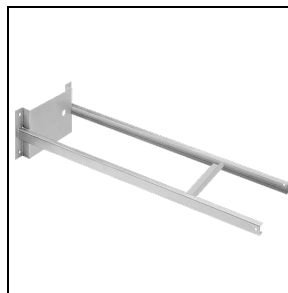

**14048694**  
1000 mm extension arm in heavy gauge steel, painted aluminium grey



**14051394**  
Double pole top mounting, Ø 60-76 mm poles, painted aluminium grey



**14057394**  
Long bracket for ceiling mounting, painted aluminium grey

To maintain the regular updating of our products, PERFORMANCE iN LIGHTING reserves the right to make changes without prior notice. For the most up to date information we always recommend you read the latest version published on the website [www.performanceinlighting.com](http://www.performanceinlighting.com). Delivered luminaire lumen outputs and power consumptions, including losses, are subject to a tolerance of +/- 7%, and unless otherwise stated the values apply to an ambient temperature of 25°C. Terms of warranty are available at [www.performanceinlighting.com/qr/qr/company/terms-and-conditions](http://www.performanceinlighting.com/qr/qr/company/terms-and-conditions)